

BIDDERS'S PROPOSAL

FOR: FENCE REMOVAL AND REPLACEMENT HORLICK ATHLETIC FIELD BASEBALL DIAMOND

SEALED BIDS DUE: Prior to 1:00 PM on June 5, 2019

**TO: Purchasing Agent
730 Washington Avenue
City Hall – Room 105
Racine, Wisconsin 53403**

The undersigned hereby proposes to furnish all labor, tools, equipment and all materials, except as definitively specified to be furnished by others and construct complete, ready for use, all in accordance with advertisement, specifications and contract, all as attached hereto and all of which the undersigned has examined, the following work for the compensation indicated:

LUMP SUM BID: FENCE REPLACEMENT – HORLICK ATHLETIC FIELD BASEBALL DIAMOND

The Contractor shall submit a Lump Sum Bid for Fence Replacement Horlick Athletic Field located at 1648 N. Memorial Drive; in accordance with these specifications as listed on Schedule "A."

TOTAL AMOUNT OF THIS PROPOSAL: _____
_____ Dollars \$ _____

Work under this contract shall be completed in 3 Phases between August 5th thru September 13th, 2019.

SUPPLEMENTAL UNIT PRICING

1. Time & Material Rate for repair of latent conditions or additional work for any portion of this project.
@ _____ Dollars /Man-hour \$ _____

Firm _____

By _____

Title _____

Date _____

Email _____

**DETAILED SPECIFICATIONS
for
FENCE REMOVAL AND REPLACEMENT HORLICK ATHLETIC FIELD BASEBALL DIAMOND**

**DIVISION 1
GENERAL CONDITIONS**

1 Scope

Contractor shall, for the bid price given, furnish all materials, labor, tools and equipment and perform all necessary work to ensure proper completion of the bid items listed on the Bidder's Proposal for Fence Replacement at Horlick Athletic Field Baseball Diamond per these specifications and attached Schedule "A."

1.2.1 **Construction Notes:**

1.2.1.1 Fence Contractor shall coordinate with Project Manager, Concrete Contractor and Excavator for installation of the fence.

1.2.1.2 Fence contractor shall anticipate fence project in three phases:

1.2.1.2.1 Fence contractor may submit pay requests upon completion of each phase of the fence project scope.

1.2.1.2.2 Demolition – before concrete contractor begins excavation.

1.2.1.2.3 Installation of all posts – once forms are set and before pouring concrete.

1.2.1.2.4 Installation of fabric – after concrete, asphalt and synthetic turf have been installed.

1.2.1.3 Project Manager will set grades and monitor grades throughout project.

1.2.1.4 Concrete curb installation will be top priority followed by fence Installer.

1.2.1.5 Spoils from fence removal and reinstallation shall be removed daily.

1.2.2 **Project Scope** will three (3) distinct phases to include:

1.2.2.1 **Phase 1 - Demolition and salvage.**

1.2.2.1.1 Fence demolition will be selective.

1.2.2.1.2 Remove fabric per plans and specifications.

1.2.2.1.3 Remove line posts as noted on plans. Note: 4" backstop poles and upper fabric to remain.

1.2.2.1.4 Materials that can be reused shall be saved for re-installation.

1.2.2.2 **Phase 2 - Rough installation**

1.2.2.2.1 Installation of posts without fabric, cross-bracing or gates.

1.2.2.3 **Phase 3 - Installation of fabric, cross-bracing and gates.**

1.2.2.3.1 Installation of reclaimed and new chainlink fence components to complete scope of project as listed in plans and specifications.

2 Location

The work under this contract shall be performed at: 1648 N. Memorial Drive., Racine; Wisconsin.

DIVISION 2
STANDARDS

1 Work Included

- 1.2 Open area of exterior chainlink fence for construction traffic – area to confirmed with Project Manager.
- 1.3 Demo and removal of existing chainlink fence per plans and specifications.
- 1.4 Deconstruct and reclaim reusable portions of existing chainlink fence, move to Owner designated storage area.
- 1.5 Stage installation of rough and finished fence per Project Manager’s Direction
- 1.6 Supply chainlink fence framework, fabric, and accessories as required.
- 1.7 Install reclaimed and new chainlink fence framework, fabric, and accessories.
- 1.8 Restore exterior fence, construction entrance.
- 1.9 Restoration of any disturbed turf related to fence installation.

2 Related Work

- 2.2 Remove all concrete, asphalt or metallic spoils from fence demolition
- 2.3 Remove and replace any signage attached to the existing fence.

3 Work Not Included – Work By Others

- 3.2 Removal of earthen spoils.
- 3.3 Excavation other than required for fence installation.
- 3.4 Concrete replacement or removal not related to fence demolition.
- 3.5 Installation of Storm Sewer.
- 3.6 Installation of Synthetic Turf.

4 References

- 4.2 Chain Link Fence Manufacturers Institute (CLFMI) Standards.

5 Quality Assurance

- 5.2 Perform Work in accordance with CLFMI — Product Manual, Manufacturer’s Instructions and “Best Industry Standards.”

6 Qualifications

- 6.2 Contractor shall specialize in commercial quality fencing and fence installations for a minimum of three (3) years.

7 Field Measurements

- 7.2 Verify that field measurements are as instructed by the manufacturer.
- 7.3 Contractor is responsible for all field measurements.

8 References

- 8.2 ASTM A123 — Zinc (Hot Dip Galvanized) Coatings on Iron and Steel Products.
- 8.3 ASTM A153 — Zinc Coating (Hot-Dip) on Iron and Steel Hardware.
- 8.4 ASTM A392 — Zinc-Coated Steel Chain-Link Fence Fabric.
- 8.5 ASTM A428 — Test Method for Weight of Coating on Aluminum-Coated Iron or Steel Articles.
- 8.6 ASTM A491 — Aluminum-Coated Steel Chain Link Fence Fabric.
- 8.7 ASTM A569 — Steel, Carbon (0.15 Max. %), Hot-Rolled Sheet and Strip Commercial Quality.
- 8.8 ASTM A653 — Steel Sheet, Zinc-Coated (Galvanized) or Zinc-Iron Alloy-Coated (Galvannealed) by the Hot-Dip Process.
- 8.9 ASTM A792 — Steel Sheet, 55% Aluminum-Zinc Alloy-Coated by the Hot-Dip Process.
- 8.10 ASTM A824 — Metallic Coated Steel Marcellled Tension Wire for Use with Chain Link Fence.
- 8.11 ASTM B429 — Aluminum-Alloy Extruded Structural Pipe and Tube.

- 8.12 ASTM C94 — Ready-mixed Concrete.
- 8.13 ASTM F567 — Practice for Installation of Chain-Link Fence.
- 8.14 ASTM F900 — Industrial and Commercial Swing Gates.
- 8.15 ASTM F1043 — Strength & Protective Coatings on Metal Industrial Chain Link Fence Framework.
- 8.16 ASTM F1083 — Pipe, Steel, Hot-Dipped Zinc-Coated (Galvanized) Welded, for Fence Structures.
- 8.17 ASTM F1184 — Industrial and Commercial Horizontal Slide Gates.
- 8.18 CLFMI (Chain Link Fence Manufacturers Institute) — Product Manual.

DIVISION 3
PRODUCTS & INSTALLATION

1 Materials

1.2 Fabric

- 1.2.1 CL4-GBW — 2" mesh number 9 gauge, GALVANIZED BEFORE WEAVING. Zinc coating to be minimum 1.2 oz. per square foot of wire surface area per ASTM A-392 Class 1. Breaking strength shall be per U.S. Gov't. Spec. RR-F-191 1A-1290 lbs.
- 1.2.2 CL4-GBW — 2" mesh number 6 gauge, GALVANIZED BEFORE WEAVING. Zinc coating to be minimum 1.2 oz. per square foot of wire surface area per ASTM A-392 Class 1. Breaking strength shall be per U.S. Gov't. Spec. RR-F-191 1A-1290 lbs.

2 Framework

- 2.2 General — unless otherwise stated in this section, all steel parts shall be galvanized by the hot-dip process in accordance with the relevant and most recent ASTM Specification: Pipe Posts — ASTM F-1083, C-Posts — ASTM F-1023 ALUMINIZED.
- 2.3 Line Posts — Fabric height over 6 feet.
 - 2.3.1 'C' section weighing 1.60 lbs. /ft. (1-5/8" x 1-7/8").
 - 2.3.2 2" O.D., Sch. 40 2.72 lbs. /ft. SS40 2.28 lbs. /ft.
 - 2.3.3 3" O.D. Sch. 40 5.79 lbs. /ft., S540 4.46 lbs. /ft.*
- 2.4 Terminal Posts — For fence fabric above 6'.
 - 2.4.1 3" O.D. Sch. 40 5.79 lbs. /ft., SS40 4.64 lbs. /ft.
- 2.5 Gate Posts — Single or one leaf of double gate
 - 2.5.1 Over 6'0" to 13'0" — 4" O.D. Sch. 40 9.11 lbs. /ft.
- 2.6 Top Rail, Braces. Tension Wire, Etc.
 - 2.6.1 Top rail (when specified) — the fence shall have a continuous top rail for its full length of 1-5/8" O.D. galvanized pipe or a 1-5/8" x 1-1/4" roll form section. In either case, minimum bending strength shall be 202 lbs. at the Center of a 10' span. The top rail shall pass through openings provided in the line post tops and each length shall be coupled in an approved manner. Fabric shall be attached to the top rail by means of **#6 gauge aluminum ties** spaced at intervals of approximately 24".
 - 2.6.2 Tension Wire (#7 - .177") gauge tension wire having an aluminum coating of .40 oz. per sq. ft. (ASTM A824) shall be provided along the bottom of the fence. Fabric shall be fastened to the tension wire at intervals of 24" with 6 gauge wire.
 - 2.6.3 Truss Braces — for all fences, a double brace and truss shall be installed at each terminal post. The brace rail shall be of the same material as specified for the top rail. A 3/8" adjustable truss rod with turnbuckle shall be installed between the terminal and first adjacent line post.
 - 2.6.4 Tension Bars, Bands & Fittings (ASTM F626) — for fence using round pipe posts, fabric shall be attached by means of 7/8" wide bands and tension bar. Fabric shall be attached to line posts by **#6 gauge aluminum ties**, intervals not to exceed 15".

- 2.7 Post Tops — galvanized steel, weather tight closure cap, for posts, one cap for each post. Furnish cap with opening to permit passage of top rail.
- 2.8 Swing Gates — gate frames shall be constructed of minimum 2" O.D. galvanized pipe. Gate frame shall be welded at all corners to form a rigid panel, and filled with fabric to match the fence. The hinges shall allow the gate to swing 180 degrees. The latches for both the double and single gates shall be heavy duty and have a provision for padlocking.

3 Installation

- 3.2 General — the chain link fence, gates and accessories shall be installed in strict accordance with plans and specifications in a workmanlike manner. The installers shall be skilled in this type of construction.
- 3.3 TERMINAL posts, minimum 3" schedule 40, to be driven to a minimum depth of 6' below grade.
- 3.4 CORNER posts, minimum 4" schedule 40, to be driven to a minimum depth of 6' below grade.
- 3.5 GATE posts, minimum 4" schedule 40, to be driven to a minimum depth of 6' below grade.
- 3.6 LINE posts, minimum 2.0" schedule 40, shall be evenly spaced no farther apart than 10 feet on centers and shall be driven 4' below grade.
- 3.7 FABRIC shall be connected to line posts every 14", to top rail every 24", to end; corner and gate posts using flat tension bars connected to the post every 14" with steel bands with bolts and nuts.
- 3.8 FENCE shall follow the ground. Lines and grades will be established by others.
- 3.9 ALL material may be subject to site testing for compliance to the above specifications with standard tolerances to apply.

4 Quality Assurance and Standards

- 4.2 The Contractor shall employ adequate numbers of experienced, skilled tradesmen for the work, who are familiar with all the methods, materials, requirements and their standards needed for the proper performance of the work specified and in accordance with best industry standards.

5 Hardware Installation

- 5.2 Install hardware in accordance with the manufacturer's printed instructions and ANSI standards using proper templates.

6 Special Conditions

- 6.2 Football portion of Horlick Athletic Field will be open for afternoon football games. Contractor shall ensure project related equipment and vehicles stay within designated project boundaries.
- 6.3 Fence installation will be a three phase project. Billing after completion of each phase of the project will be approved.
- 6.4 Contractor shall leave all excavated "soils only" on site, at a location designated by the Owner.

DIVISION 4 **FINAL INSPECTION AND CLEANUP**

1 General

- 1.2 Any existing equipment or structure, damaged during the course of execution of any phase of this contract, shall be repaired by the Contractor at the Contractor's expense. This includes any replacements needed, as determined by the Parks Department to restore damaged equipment or structure(s).

- 1.3 All refuse associated with any phase of this contract shall be immediately cleaned up and removed by the Contractor.

DIVISION 5
TIME LIMIT

1 **General**

Work under this contract shall be completed in 3 Phases between August 5th thru September 13th, 2019.

DIVISION 6
GUARANTEE

1 **General**

- 1.2 Contractor shall agree and guarantee that the materials, equipment and workmanship supplied by the contractor, shall be free from all defects and strictly in accordance with the specifications at the time of its completion and acceptance by the City of Racine and for a period of one (1) year, thereafter; and in case of any cracks, leaks or settlement or any other defects as to materials, equipment or workmanship existing or appearing in any part of the work constructed by contractor within one (1) year thereafter, the Contractor agrees to forthwith repair the same upon notification by the City using the same materials required by this specification and in case the Contractor shall fail to make such repairs; the Contractor further agrees and guarantees to pay for all labor and material used in or about the construction of said work in this contract which may become a lien or a claim against the City. Such agreement and guarantee shall be made a part of the contract and the fulfillment thereof shall be secured by the bond of the Contractor.

DIVISION 7
INSURANCE & INDEMNIFICATION

To the fullest extent allowable by law, Contractor hereby indemnifies and shall defend and hold harmless the City of Racine, its elected and appointed officials, officers, employees or authorized representatives or volunteers and each of them from and against any and all suits, actions, legal or administrative proceedings, claims, demands, damages, liabilities, interest, attorneys' fees, costs, and expenses of whatsoever kind or nature whether arising before, during, or after completion of the work hereunder and in any manner directly or indirectly caused, occasioned, or contributed to in whole or in part or claimed to be caused, occasioned, or contributed to in whole or in part, by reason of any act, omission, fault, or negligence, whether active or passive, of Contractor or of anyone acting under its direction or control or on its behalf in connection with or incident to the performance of this Agreement regardless if liability without fault is sought to be imposed on the City of Racine, Contractor's aforesaid indemnity and hold harmless agreement shall not be applicable to any liability caused by the sole fault, sole negligence, or willful misconduct of the City of Racine, or its elected and appointed officials, officers, employees or authorized representatives or volunteers. This indemnity provision shall survive the termination or expiration of this Agreement.

In any and all claims against the City of Racine, its elected and appointed officials, officers, employees or authorized representatives or volunteers by an employee of Contractor, any subcontractor, or anyone for whose acts any of them may be liable, the indemnification obligation under this paragraph shall not be limited in any way by any limitation on the amount or type of damages, compensation, or benefits payable by or for the Contractor or any subcontractor under Worker's Compensation Acts, Disability Benefit Acts, or other employee benefit acts.

No provision of this Indemnification clause shall give rise to any duties not otherwise provided for by this Agreement or by operation of law. No provision of this Indemnity clause shall be construed to negate, abridge, or otherwise reduce any other right or obligation of indemnity that would otherwise exist as to the City of Racine, its elected and appointed officials, officers, employees or authorized representatives or volunteers under this or any other contract. This clause is to be read in conjunction with all other indemnity provisions contained in this Agreement. Any conflict or ambiguity arising between any indemnity provisions in this Agreement shall be construed in favor of indemnified parties except when such interpretation would violate the laws of the state in which the job site is located. Contractor shall reimburse the City of Racine, its elected and appointed officials, officers, employees or authorized representatives or volunteers for any and all legal expenses and costs incurred by each of them in connection therewith or in enforcing the indemnity herein provided. Contractor's obligation to indemnify shall not be restricted to insurance proceeds, if any, received by the City of Racine, its elected and appointed officials, officers, employees or authorized representatives or volunteers.

Insurance Requirements

The Contractor shall not commence work under a contract until he has obtained all insurance required under this paragraph and has filed certificates thereof with the Owner, nor shall the Contractor allow a Subcontractor to commence work until all similar insurance required has been so obtained and filed with the Contractor. Unless otherwise specified in this Agreement, the Contractor shall, at its sole expense, maintain in effect at all times during the performance of the Work, insurance coverage with limits not less than those set forth below with insurers and under forms of policies set forth below.

Worker's Compensation and Employers Liability Insurance - The Contractor shall cover or insure under the applicable labor laws relating to worker's compensation insurance, all of their employees in accordance with the law in the State of Wisconsin. The Contractor shall provide statutory coverage for work related injuries and employer's liability insurance with limits of \$1,000,000 each accident, \$1,000,000 disease policy limit, and \$1,000,000 disease each employee.

Commercial General liability and Automobile Liability Insurance - The Contractor shall provide and maintain the following commercial general liability and automobile liability insurance:

Coverage – Coverage for commercial general liability and automobile liability insurance shall be at least as broad as the following:

1. Insurance Services Office (ISO) Commercial General Liability Coverage (Occurrence Form CG0001)
2. Insurance Services Office (ISO) Business Auto Coverage (Form CA0001), covering Symbol 1 (any vehicle)

Limits -The Contractor shall maintain limits no less than the following:

1. General Liability - One million dollars (\$1,000,000) per occurrence (\$2,000,000 general aggregate if applicable) for bodily injury, personal injury and property damage. If Commercial General Liability Insurance or other form with a general aggregate limit is used, either the general aggregate limit shall apply separately to the project/location (with the ISO CG 2503, or ISO CG 2504, or insurer's equivalent endorsement provided to the City of Racine) or the general aggregate including product-completed operations aggregate limit shall be twice the required occurrence limit.

2. Automobile Liability- One million dollars (\$1,000,000)for bodily injury and property damage per occurrence limit covering all vehicles to be used in relationship to the Agreement.

3. Umbrella Liability- One Million dollars (\$1,000,000) for bodily injury, personal injury and property damage per occurrence in excess of coverage carried for Employers' Liability, Commercial General Liability and Automobile Liability as described above.

Required Provisions - The general liability and automobile liability policies are to contain, or be endorsed to contain, the following provisions:

1. The City of Racine, its elected and appointed officials, officers, employees or authorized representatives or volunteers are to be given additional insured status as respects liability arising out of activities performed by or on behalf of the Contractor; on products and completed operations of the Contractor; for premises occupied or used by the Contractor; and on any vehicles owned, leased, hired or borrowed by the Contractor.

2. The coverage shall contain no special limitations on the scope of protection afforded to the City of Racine, its elected and appointed officials, officers, employees or authorized representatives or volunteers.

3. For any claims related to this project, the Contractor's insurance shall be primary insurance as respects the City of Racine, its elected and appointed officials, officers, employees or authorized representatives or volunteers. Any insurance, self-insurance, or other coverage maintained by the City of Racine, its elected and appointed officials, officers, employees, or authorized representatives or volunteers shall not contribute to it.

4. Any failure to comply with reporting or other provisions of the policies including breaches of warranties shall not affect coverage provided to the City of Racine, its elected and appointed officials, officers, employees or authorized representatives or volunteers.

5. The Contractor's insurance shall apply separately to each insured against whom claim is made or suit is brought, except with respect to the limits of the insurer's liability.

6. Each insurance policy required by this agreement shall state, or be endorsed to state, that coverage shall not be canceled by the insurance carrier or the Contractor, except after sixty (60) days (or 10 days for non-payment of premium) prior written notice by U.S. mail has been given to the City of Racine.

7. Such liability insurance shall indemnify the City of Racine, its elected and appointed officials, officers, employees or authorized representatives or volunteers against loss from liability imposed by law upon, or assumed under contract by, the Contractor for damages on account of such bodily injury (including death), property damage, personal injury, completed operations, and products liability.

8. The general liability policy shall cover bodily injury and property damage liability, owned and non-owned equipment, blanket contractual liability, completed operations liability with a minimum of a 24 month policy extension, explosion, collapse, underground excavation, and removal of lateral support, and shall not contain an exclusion for what is commonly referred to by the insurers as the "XCU" hazards. The automobile liability policy shall cover all owned, non-owned, and hired vehicles. All of the insurance shall be provided on policy forms and through companies satisfactory to the City of Racine, and shall have a minimum A.M. Best's rating of A-VII.

Deductibles and Self-Insured Retentions - Any deductible or self-insured retention must be declared to and approved by the City of Racine. At the option of the City of Racine, the insurer shall either reduce or eliminate such deductibles or self-insured retentions.

Evidences of Insurance - Prior to execution of the agreement, the Contractor shall file with the City of Racine a certificate of insurance (Acord Form 25-S or equivalent) signed by the insurer's representative evidencing the coverage required by this agreement. Such evidence shall include an additional insured endorsement signed by the insurer's representative. Such evidence shall also include confirmation that coverage includes or has been modified to include all required provisions 1-8.

Responsibility for Work - Until the completion and final acceptance by the City of Racine of all the work under and implied by this agreement, the work shall be under the Contractor's responsibility care and control. The Contractor shall rebuild, repair, restore and make good all injuries, damages, re-erections, and repairs occasioned or rendered necessary by causes of any nature whatsoever.

Sub-Contractors - In the event that the Contractor employs other contractors (subcontractors) as part of the work covered by this agreement, it shall be the Contractor's responsibility to require and confirm that each sub-contractor meets the minimum insurance requirements specified above.

END OF SPECIFICATIONS
SCHEDULE "A." – NM&B Plan # 2018.0021.01

CONSTRUCTION PLANS
for
HORLICK ATHLETIC FIELD
ARTIFICIAL TURF INSTALLATION
for
THE CITY OF RACINE PARKS & RECREATION DEPARTMENT
City of Racine, Racine County, Wisconsin



RACINE

LEGEND

Description	Existing	Description	Existing	Proposed
EDGE OF WOODS		WATER SHUT OFF		
DECIDUOUS TREE		WATER MAIN VALVE		
DECIDUOUS TREE REMOVAL		HYDRANT		
CONIFEROUS TREE		WATER MAIN REDUCER		
CONIFEROUS TREE REMOVAL		SANITARY MANHOLE		
BUSH		SANITARY CLEAN OUT		
SOIL BORING		STORM MANHOLE		
TELEPHONE BOX		CATCH BASIN		
GUY WIRE		LIGHT POLE		
UTILITY POLE		ENDWALL		
GAS VALVE		STORM SEWER		
GAS METER		SANITARY SEWER		
SEPTIC VENT		WATERMAIN		
ELECTRIC MANHOLE		CONTOURS		
COMMUNICATION MANHOLE		FIRE PROTECTION		
WATER MANHOLE		UTILITY CROSSING		
HVAC UNIT		DITCH OR SWALE		
UNDERGROUND VAULT		CULVERT		
SECTION CORNER		RAILROAD TRACKS		
MAIL BOX		FENCE		
GUARD POST		NO VEHICULAR ACCESS		
STREET SIGN		UNDERGROUND ELECTRIC		
ELECTRIC PEDESTAL		UNDERGROUND GAS MAIN		
ELECTRIC METER		UNDERGROUND COMMUNICATIONS		
PAD MOUNT TRANSFORMER		SILT FENCE		
FOUND IRON PIPE		OVERHEAD ELECTRIC		
SET IRON PIPE		FORCE MAIN		

ABBREVIATIONS

BASE LINE	BL	INVERT ELEVATION	IE
LONG CORD OF CURVE	CHD	LENGTH OF CURVE	ARC
CURB AND GUTTER	CSG	MANHOLE	MH
CATCH BASIN	CB	NORMAL WATER LEVEL	NWL
CENTERLINE	CL	POINT OF CURVATURE	PC
EDGE OF PAVEMENT	EOP	POINT OF TANGENCY	PT
FINISHED FIRST FLOOR	EFF	TANGENCY OF CURVE	TAN
FINISHED GRADE	FG	POINT OF VERTICAL INTERSECTION	PVI
FLOW LINE	FL	RADIUS	R
FLOODPLAIN	FP	RIGHT OF WAY	ROW
ORDINARY HIGH WATER MARK	OHWM	SANITARY SEWER	SAN
TOP OF BANK	TOB	STORM SEWER	STM
TOP OF CURB	TOC	TOP OF FOUNDATION	TOF
TOP OF WALK	TOW	WATER MAIN	WM

UTILITY NOTE

EXISTING UTILITIES ARE SHOWN FOR INFORMATIONAL PURPOSES ONLY AND ARE NOT GUARANTEED TO BE ACCURATE OR ALL INCLUSIVE. CONTRACTOR IS RESPONSIBLE FOR VERIFYING THE TYPE, LOCATION, SIZE AND ELEVATION OF UNDERGROUND UTILITIES AS THEY DEEM NECESSARY FOR PROPOSED UTILITY CONNECTIONS AND / OR TO AVOID DAMAGE THERETO, CONTRACTOR SHALL CALL "DIGGER'S HOTLINE" PRIOR TO ANY CONSTRUCTION.

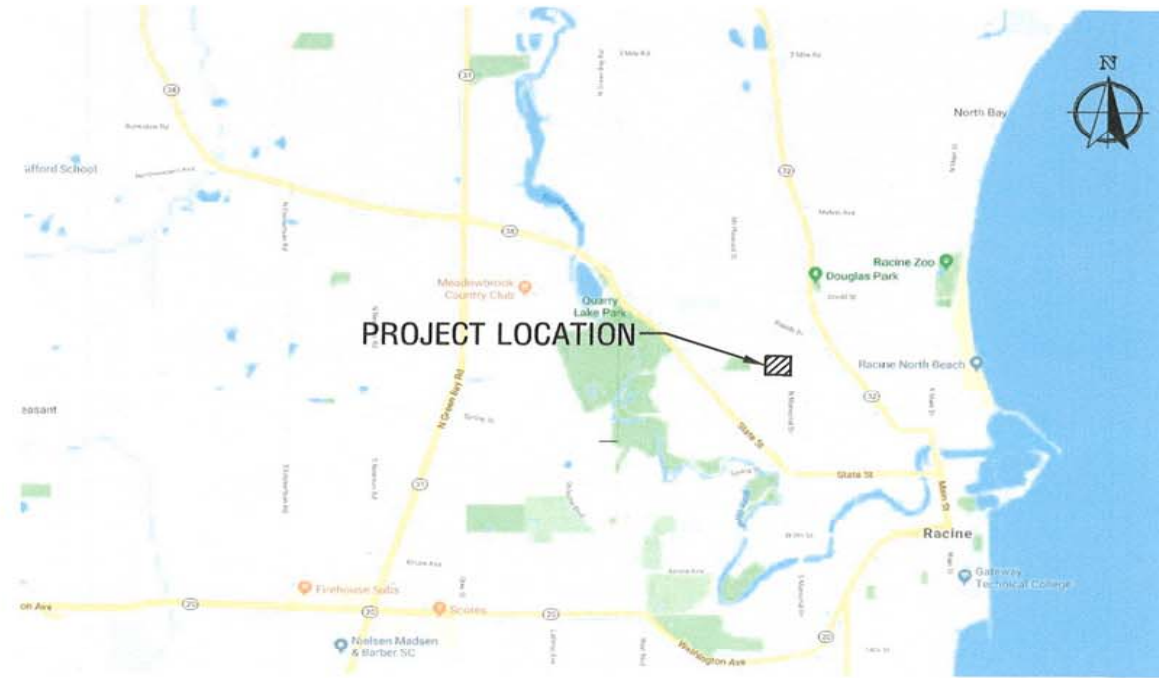

SHEET INDEX

PLAN SHEET	SHEET NO.
TITLE SHEET	C-1
EXISTING CONDITIONS TOPOGRAPHIC SURVEY	C-2
DIMENSIONED SITE PLAN	C-3
SITE DEMOLITION PLAN	C-4
SITE GRADING & EROSION CONTROL PLAN	C-5
STORM SEWER & UNDERDRAIN PLAN	C-6
SITE FENCING & RESTORATION PLAN	C-7
TYPICAL SECTIONS & CONSTRUCTION DETAILS	C-8 thru C-9

GOVERNING AGENCIES CONTACTS

CITY OF RACINE - DEPARTMENT OF PUBLIC WORKS
MARK H. YEHLIN, COMMISSIONER
COMMISSIONER OF PUBLIC WORKS OFFICE: 262-636-9121
EMAIL: Mark.Yehlin@cityofracine.org

THOMAS M. EEG, ASSISTANT COMMISSIONER
ASSISTANT COMMISSIONER OF PUBLIC WORKS OFFICE: 262-636-9121
EMAIL: Thomas.Eeg@cityofracine.org

RACINE PARKS DEPARTMENT
TOM MOLBECK, PPCS DIRECTOR
OFFICE: 262-636-9131
EMAIL: Tom.Molbeck@cityofracine.org

MIKE WILLIS, PARK SUPERINTENDENT
OFFICE: 262-636-9137
EMAIL: Mike.Willis@cityofracine.org

ROBERT RAFEL, PARKS & FACILITIES SPECIALIST
OFFICE: 262-636-9135
FAX: 262-636-9177
MOBILE: 262-498-4765
EMAIL: Robert.Rafel@cityofracine.org

CITY OF RACINE - DEPARTMENT OF CITY DEVELOPMENT
AMY CONNOLLY, DIRECTOR OF CITY DEVELOPMENT
DIRECTOR OF CITY DEVELOPMENT OFFICE: 262-636-9151
EMAIL: CityDevelopment@cityofracine.org

CITY OF RACINE - ENGINEERING DEPARTMENT
JOHN ROONEY, ASSISTANT COMMISSIONER/CITY ENGINEER
ENGINEERING DEPARTMENT OFFICE: 262-636-9151
EMAIL: John.Rooney@cityofracine.org

CITY OF RACINE - BUILDING INSPECTION DEPARTMENT
KENNETH D. PLASKI, CHIEF BUILDING INSPECTOR
BUILDING DEPARTMENT OFFICE: 262-636-9329
EMAIL: Ken.Plaski@cityofracine.org

PUBLIC UTILITY CONTACTS

RACINE WATER UTILITY
KEITH HAAS
GENERAL MANAGER
OFFICE: 262-636-9434
EMAIL: Keith.Haas@cityofracine.org

TDS TELECOM
SOUTHEAST WISCONSIN
OFFICE: 877-483-7142

WE-ENERGIES
DAVID SATTLER
CITY OF RACINE
OFFICE: (262) 552-3280
EMAIL: david.sattler@we-energies.com

NATURAL GAS EMERGENCY: (800) 261-5325
ELECTRICAL EMERGENCY: (800) 662-4797

TIME WARNER CABLE
STEVE CRAMER
UTILITY COORDINATOR
OFFICE: 414-277-4045
EMAIL: steve.cramer@twcable.com
EMERGENCY NUMBER: (800) 627-2288

AT&T
MIKE TOYK
OFFICE: 262-636-0549
EMAIL: mt1734@att.com

BENCH MARKS

- LIGHT POLE BOLT**
THE NORTH BOLT OF THE LIGHT POLE LOCATED ON THE LEFT FIELD FENCE LINE.
ELEVATION: 635.35
- LIGHT POLE BOLT**
THE SOUTH BOLT OF THE LIGHT POLE LOCATED 3.6' SOUTH OF MAINTENANCE BUILDING.
ELEVATION: 635.96



Nielsen Madsen + Barber
CIVIL ENGINEERS AND LAND SURVEYORS
1458 Horizon Blvd, Suite 200, Racine, WI, 53406
Tele: (262)634-5588 Website: www.nmbssc.net

HORLICK ATHLETIC FIELD
ARTIFICIAL TURF INSTALLATION (R1)
FOR
RACINE PARKS DEPARTMENT
CITY OF RACINE, RACINE COUNTY, WISCONSIN

NO.	REVISION	BY	DATE

PROJ MGR: MDE
DRAFTED: JEG
DATE: 9-11-2018
CHECKED: ALJ
DATE: 9-11-2018

2018.0021.01

SHEET
C-1

ISSUE FOR BIDS: 9-11-2018

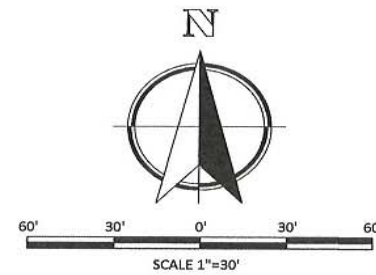
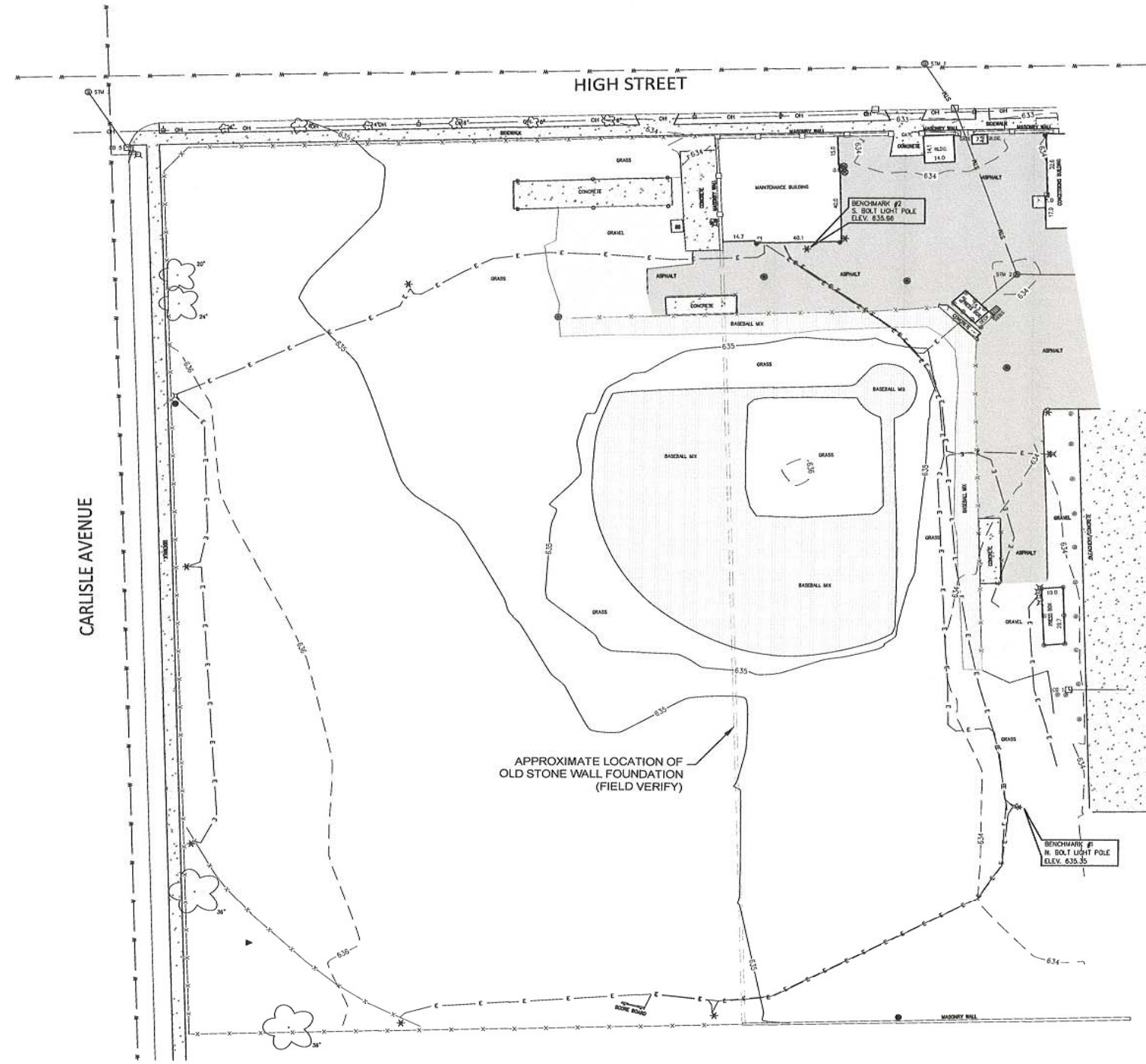

NOTE
 DEPTH OF ELECTRIC LINES UNKNOWN. FIELD VERIFY PRIOR TO CONSTRUCTION.
 LOCATION AND DEPTH OF IRRIGATION LINES UNKNOWN. FIELD VERIFY PRIOR TO CONSTRUCTION.

EXISTING UTILITY DATA			
STM 1	RIM 632.73	IE. 12" SE 627.33	IE. 8" S 627.43
		IE. 12" WNW 626.78	IE. 12" ENE 629.13
		IE. 21" E 623.73	IE. 21" N 623.73
			IE. 12" SSE 630.55
			IE. 12" SW 629.45
			IE. 12" NW 629.95
			IE. 12" NE 630.25
			IE. 24" S 628.95
STM 2	RIM 633.82	IE. 6" SW 629.72	IE. 8" E 629.22
		IE. 8" N 629.17	
STM 3	RIM 635.80	IE. 12" SSE 630.55	IE. 12" SW 629.45
		IE. 12" NW 629.95	IE. 12" NE 630.25
		IE. 24" S 628.95	
CB 1	RIM 633.07	IE. 8" E 630.77	
CB 5	RIM 634.70	IE. 12" NNW 631.10	

ALL ELEVATIONS REFER TO NATIONAL GEODETC DATUM OF 1929.

- LEGEND:**
- ⊕ STORM MANHOLE
 - CATCH BASIN
 - STM — STORM SEWER
 - DOWNSPOUT
 - ⊗ GAS METER
 - ⊠ SIGN
 - X — FENCE
 - PAD MOUNT TRANSFORMER
 - ⊗ ELECTRIC PEDESTAL
 - ⊠ ELECTRIC METER
 - COMMUNICATION BOX
 - ⊗ LIGHT POLE
 - POWER POLE
 - OH — OVERHEAD WIRES
 - ⊗ DECIDUOUS TREE
 - ⊕ 2" DIA COLUMN
 - 4" DIA POLE
 - ⊕ 1.5" DIA POLE
 - ⊗ GUARD POST

DIGGERS HOTLINE
 Call 811 or (800) 242-8511
 www.DiggersHotline.com

UTILITY NOTE
 EXISTING UTILITIES ARE SHOWN FOR INFORMATIONAL PURPOSES ONLY AND ARE NOT GUARANTEED TO BE ACCURATE OR ALL INCLUSIVE. CONTRACTOR IS RESPONSIBLE FOR VERIFYING THE TYPE, LOCATION, SIZE AND ELEVATION OF UNDERGROUND UTILITIES AS THEY DEEM NECESSARY FOR PROPOSED UTILITY CONNECTIONS AND / OR TO AVOID DAMAGE THERETO. CONTRACTOR SHALL CALL "DIGGER'S HOTLINE" PRIOR TO ANY CONSTRUCTION.



Nielsen Madsen + Barber
 CIVIL ENGINEERS AND LAND SURVEYORS
 1458 Horizon Blvd. Suite 200, Racine, WI. 53406
 Tele: (262)634-5588 Website: www.nmbasc.net

HORLICK ATHLETIC FIELD
 EXISTING CONDITIONS TOPOGRAPHIC SURVEY
 FOR
 RACINE PARKS DEPARTMENT
 CITY OF RACINE, RACINE COUNTY, WISCONSIN

NO.	REVISION	BY	DATE

PROJ. MGR: MDE
 DRAFTED: JEG
 DATE: 9-11-2018
 CHECKED: ALJ
 DATE: 9-11-2018
 2018.0021.01
 SHEET
C-2

ISSUE FOR BIDS: 9-11-2018

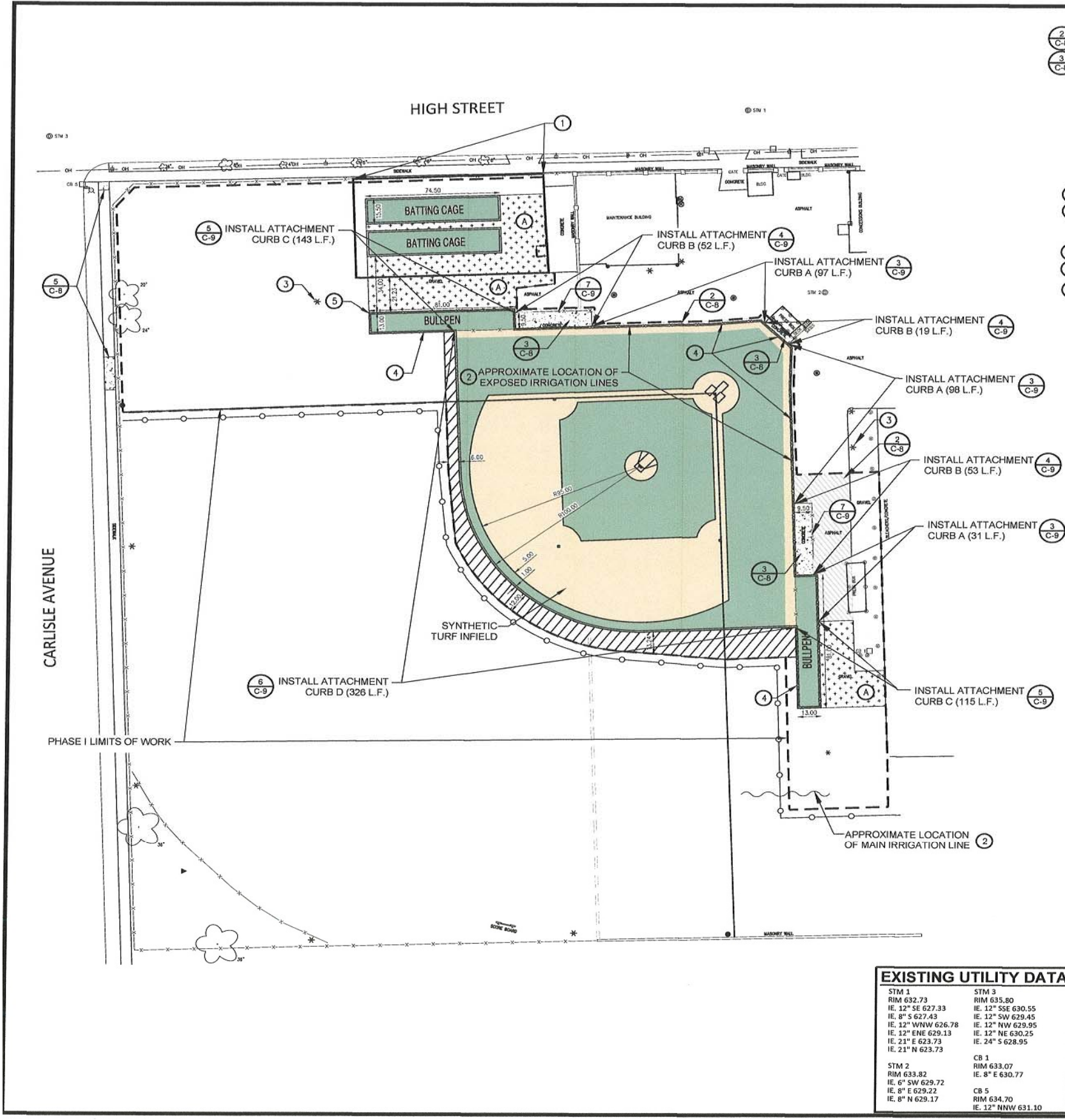

- SITE LEGEND**
- 2 C-8 MEDIUM DUTY ASPHALT PAVEMENT
 - 3 C-8 LIGHT DUTY CONCRETE PAVEMENT
 - SOD TRANSITION STRIP
 - GRAVEL SURFACE
 - CONSTRUCTION FENCE
 - A PROPOSED GRAVEL SURFACES TO BE CONSTRUCTED OF SALVAGED GRAVEL (6" BASE) AND 3/4" CRUSHED LIMESTONE (4" TOP DRESS)

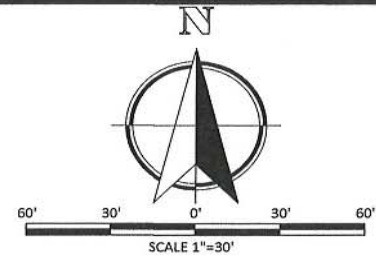

- NOTES**
1. BATTING CAGES AND ALL ASSOCIATED PAVEMENTS, FENCING, STORM SEWER AND REMOVALS ARE PART OF ALTERNATE BID 1.
 2. FIELD VERIFY LOCATION, SIZE AND ELEVATION OF EXISTING IRRIGATION LINES PRIOR TO ANY EARTHWORK ACTIVITIES.
 - IF LOCATED WITHIN LIMITS OF SYNTHETIC TURF INFIELD, ABANDON IN PLACE.
 - IF LOCATED WITHIN LIMITS OF SOD TRANSITION STRIP, FLAG EXPOSURE FOR OWNER'S ATTENTION.
 3. FIELD VERIFY LOCATION AND ELEVATION OF EXISTING ELECTRIC LINES PRIOR TO ANY EARTHWORK ACTIVITIES AND PROTECT DURING CONSTRUCTION.
 4. SEE SHEET C-7 FOR SITE FENCING PLAN.
 5. FENCING CONTRACTOR TO INSTALL 12" H X 6" DIA. CORNER FENCE POST WITH 6" DEEP FOUNDATION AND CAP TO SERVE AS NEW SAFETY NET POST. CABLES AND NETTING TO BE INSTALLED BY OTHERS.

- WORK SCOPE**
- ITEMS TO BE PROVIDED BY OWNER**
1. CONSTRUCTION STAKING & LAYOUT.
 2. INSTALLATION & REMOVAL OF TEMPORARY CONSTRUCTION FENCING.
 3. DUMP SITE FOR SPOILS (0.46 MILES FROM PROJECT SITE AT 1425 N. MEMORIAL DRIVE).

- WORK SCOPE A - EXCAVATION & STORM SEWER IMPROVEMENTS**
1. INSTALL PERIMETER EROSION CONTROL.
 2. DEMOLISH EXISTING WOODEN NET POST.
 3. SAW CUT & REMOVE ASPHALT AND CONCRETE PAVEMENTS AS NEEDED TO INSTALL ALL PROPOSED IMPROVEMENTS.
 - A. HAUL OFF SITE AND COORDINATE DISPOSAL AT NON-CITY-OWNED LOCATION.
 4. EXCAVATE APPROXIMATELY 2,300 CY OF MATERIAL FROM THE EXISTING BASEBALL FIELD AND HAUL TO DESIGNATED DUMP SITE, PER PLANS AND SPECIFICATIONS.
 5. FINE GRADE ALL SUB-GRADES AND CONDUCT NECESSARY PROOF ROLLS.
 6. IF REQUIRED, EXCAVATE ALL SOFT AREAS AND REPLACE WITH SATISFACTORY COMPACTED STRUCTURAL MATERIAL.
 - A. PROVIDE PRICE PER CY IN PROPOSAL.
 7. INSTALL APPROXIMATELY 300 LF OF STORM SEWER ON NORTHWEST AND SOUTHEAST CORNERS OF THE BASEBALL DIAMOND PER PLANS AND SPECIFICATIONS.
 8. UNDERCUT AND OVERFILL AREAS NECESSARY AND PLACE TOPSOIL AND GRAVEL SURFACES TO THE LINES AND GRADES AS SHOWN ON THE PLANS.

WORK SCOPE C - FENCING IMPROVEMENTS

- A. DEMOLITION**
1. CONSTRUCTION OPENING IN EXTERIOR CHAIN-LINK FENCE FOR CONSTRUCTION ENTRANCE AND INSTALL GATE AND LOCK.
 2. PERFORM SELECTIVE DEMOLITION
 - A. REMOVE ALL CONCRETE, ASPHALT, SOIL AND METALLIC SPOILS FROM FENCE DEMOLITION AND HAUL OFF SITE.
 3. REMOVE FENCING FABRIC PER THE PLANS AND SPECIFICATIONS AND SALVAGE SELECT MATERIALS TO THE OWNER.
 4. REMOVE LINE POSTS AND CONCRETE FOUNDATIONS AS NOTED ON CONSTRUCTION PLANS.
 - A. NOTE: 4" BACKSTOP POSTS AND UPPER BACKSTOP FABRIC TO REMAIN IN PLACE.
 - B. MATERIALS THAT CAN BE REUSED SHALL BE SALVAGED FOR RE-INSTALLATION.
 3. REMOVE CONCRETE FROM UPPER 12" OF 4" BACKSTOP POSTS.
- B. INSTALLATION**
1. INSTALL DRIVEN LINE POSTS.
 2. INSTALL END POSTS, NOT INTRINSIC TO THE CONCRETE CURB, IN CONCRETE.
 - A. ALL POSTS SHALL BE INSTALLED AFTER FORMS FOR CONCRETE CURBS ARE PLACED.
 - I. COORDINATE WITH CONCRETE CURB INSTALLER.
 3. INSTALL RECLAIMED AND NEW FENCING FABRIC, BRACES AND GATES AS REQUIRED TO COMPLETE PROJECT.
 - A. FINAL INSTALLATIONS TO TAKE PLACE AFTER TURF AND ADJACENT PAVEMENTS ARE COMPLETE.
 4. CONTRACTOR SHALL REPURPOSE AS MUCH RECLAIMED FENCE MATERIAL AS REASONABLE, INCLUDING BUT NOT LIMITED TO: FENCING FABRIC, BRACES, MOUNTING HARDWARE AND CAPS.
 - A. REPURPOSED MATERIAL SHALL NOT INCLUDE POSTS, TIES, GATES OR DAMAGED FABRIC.
 5. RESTORE EXTERIOR FENCING AT CONSTRUCTION ENTRANCE UPON COMPLETION OF THE PROJECT TO EXISTING CONDITIONS.

- COORDINATION REQUIRED**
1. EXCAVATION CONTRACTOR SHALL COORDINATE WITH PROJECT MANAGER, FENCING AND CONCRETE CONTRACTORS.
 2. PROJECT ENGINEER WILL SET GRADES AND MONITOR GRADES THROUGHOUT PROJECT.
 3. CONCRETE CURB INSTALLATION WILL BE TOP PRIORITY, THEN FENCE INSTALLER, AND EXCAVATION & STORM SEWER INSTALLATION WILL FOLLOW.
 4. DISPOSAL OF ALL TURF, STORM SEWER, UNDER DRAIN, FENCING AND CONCRETE CURB SPOILS FROM EXCAVATION IS INCLUDED IN WORK SCOPE A.

- WORK SCOPE B - CONCRETE CURB & PAVEMENT IMPROVEMENTS**
1. SAWCUT ASPHALT AND CONCRETE PAVEMENTS AS NECESSARY TO INSTALL NEW CONCRETE IMPROVEMENTS.
 - A. REMOVE PAVEMENTS AND HAUL OFF SITE.
 2. EXCAVATE AS REQUIRED PER PLANS AND SPECIFICATIONS FOR FORM INSTALLATION. A REMOVAL OF ADJACENT IMPROVEMENTS FOR PLACEMENT OF CURB FORMS IS INCLUDED IN THE PROJECT SCOPE.
 - B. SPOILS FROM EXCAVATION TO REMAIN ON SITE (COORDINATE WITH OWNER).
 3. FURNISH AND INSTALL REBAR AND MESH REINFORCEMENT PER PLANS AND SPECIFICATIONS.
 4. INSTALL AND FINISH CONCRETE CURBS PER PLANS AND SPECIFICATIONS.
 - A. LEAVE SUFFICIENT OPENING IN ATTACHMENT CURBS FOR TURF INSTALLER TO IMPORT REQUIRED MATERIALS.
 - I. INSTALL REMAINDER OF CURB WHEN READY.
 5. INSTALL CONCRETE SLABS AND SIDEWALKS PER PLANS AND SPECIFICATIONS.
 6. SAW CUT ALL CONTRACTION JOINTS (INCLUDING JOINT AT NEW FENCE POSTS).
 7. REMOVE FORMS AND CLEAN-UP.

- COORDINATION REQUIRED**
1. CONTRACTOR MUST COORDINATE WITH FENCE CONTRACTOR TO INSTALL LINE POSTS AFTER FORMS ARE IN PLACE - BEFORE POURING CONCRETE.
 2. CONCRETE CONTRACTOR SHALL COORDINATE WITH PROJECT MANAGER, FENCE CONTRACTOR AND EXCAVATOR FOR INSTALLATION OF THE CONCRETE CURB.
 3. PROJECT ENGINEER WILL SET GRADES AND MONITOR GRADES THROUGHOUT PROJECT.
 4. CONCRETE CURB INSTALLATION WILL BE TOP PRIORITY FOLLOWED BY FENCE LINE POST INSTALLATION.
 5. LINE FENCE & CHAIN-LINK FABRIC REMOVAL AND REPLACEMENT BY OTHERS - 4" POSTS FOR BACKSTOP WILL REMAIN.
 6. SPOILS FROM CONCRETE CURB INSTALLATION WILL REMAIN ON SITE.

- UTILITY NOTE**
- EXISTING UTILITIES ARE SHOWN FOR INFORMATIONAL PURPOSES ONLY AND ARE NOT GUARANTEED TO BE ACCURATE OR ALL INCLUSIVE. CONTRACTOR IS RESPONSIBLE FOR VERIFYING THE TYPE, LOCATION, SIZE AND ELEVATION OF UNDERGROUND UTILITIES AS THEY DEEM NECESSARY FOR PROPOSED UTILITY CONNECTIONS AND / OR TO AVOID DAMAGE THERETO, CONTRACTOR SHALL CALL "DIGGER'S HOTLINE" PRIOR TO ANY CONSTRUCTION.
- COMMUNICATION BOX
 - LIGHT POLE
 - POWER POLE
 - OVERHEAD WIRES
 - DECIDUOUS TREE
 - 2" DIA COLUMN
 - 4" DIA POLE
 - 1.5" DIA POLE
 - GUARD POST

EXISTING UTILITY DATA

STM 1 RIM 632.73 IE. 12° SE 627.33 IE. 8° S 627.43 IE. 12° WNW 626.78 IE. 12° ENE 629.13 IE. 21° E 623.73 IE. 21° N 623.73	STM 3 RIM 635.80 IE. 12° SE 630.55 IE. 12° SW 629.45 IE. 12° NW 629.95 IE. 12° NE 630.25 IE. 24° S 628.95
STM 2 RIM 633.82 IE. 6° SW 629.72 IE. 8° E 629.22 IE. 8° N 629.17	CB 1 RIM 633.07 IE. 8° E 630.77
	CB 5 RIM 634.70 IE. 12° NNW 631.10

ALL ELEVATIONS REFER TO NATIONAL GEODETIC DATUM OF 1929.

DIGGERS HOTLINE
Call 811 or (800) 242-8511
www.DiggersHotline.com

- STORM MANHOLE
- CATCH BASIN
- STORM SEWER
- DOWNSPOUT
- GAS METER
- SIGN
- FENCE
- PAD MOUNT TRANSFORMER
- ELECTRIC PEDESTAL
- ELECTRIC METER

Nielsen Madsen + Barber
CIVIL ENGINEERS AND LAND SURVEYORS
1458 Horizon Blvd. Suite 200, Racine, WI. 53406
Tel: (262)634-5588 Website: www.nmbssc.net

HORLICK ATHLETIC FIELD
DIMENSIONED SITE PLAN
FOR
RACINE PARKS DEPARTMENT
CITY OF RACINE, RACINE COUNTY, WISCONSIN

NO.	REVISION	DATE

PROJ. MGR: MDE
DRAFTED: JEG
DATE: 9-11-2018
CHECKED: ALJ
DATE: 9-11-2018

2018.0021.01
SHEET
C-3

ISSUE FOR BIDS: 9-11-2018

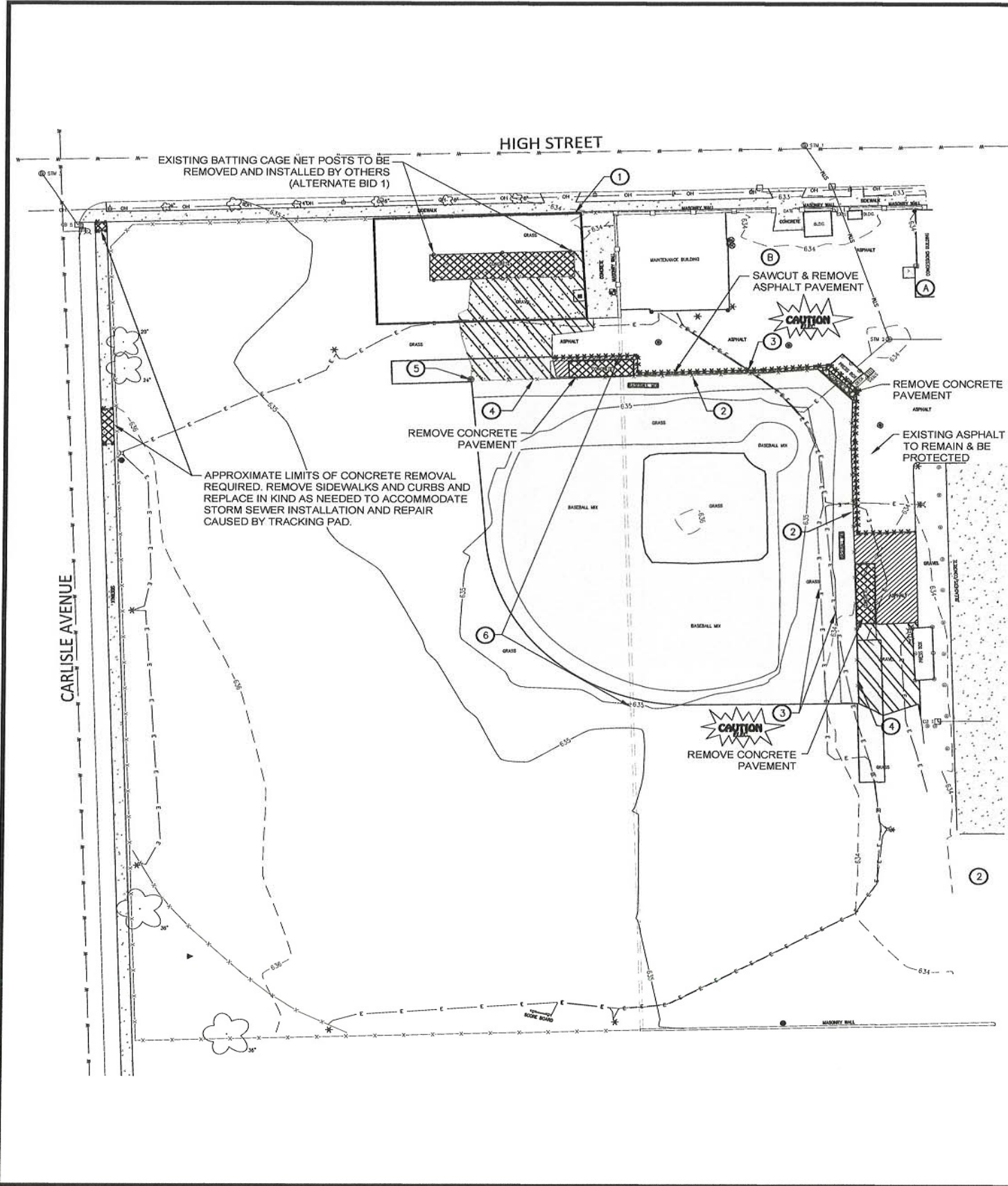

SITE DEMOLITION LEGEND

- ***** SAW CUT PAVEMENT (FULL DEPTH)
- [Cross-hatched box] REMOVE CONCRETE PAVEMENT & BASE
- [Diagonal lines box] REMOVE ASPHALT PAVEMENT & BASE
- [Dotted box] CAREFULLY REMOVE & SALVAGE GRAVEL SURFACE (TO THE MAXIMUM EXTENT POSSIBLE)
- [Empty box] EXCAVATE TO DESIGN SUBGRADE AND PREPARE FOR SYNTHETIC TURF/SOD INSTALLATION

- (A) RESTROOMS TO BE OPEN DURING CONSTRUCTION AND ARE TO BE KEPT CLEAN.
- (B) THERE SHALL BE NO PARKING OF CONSTRUCTION EQUIPMENT OR WORKER VEHICLES IN PARKING LOT DURING CONSTRUCTION.

NOTES

1. BATTLING CAGES AND ALL ASSOCIATED PAVEMENTS, FENCING, STORM SEWER AND REMOVALS ARE PART OF ALTERNATE BID 1.
2. FIELD VERIFY LOCATION, SIZE AND ELEVATION OF EXISTING IRRIGATION LINES PRIOR TO ANY EARTHWORK ACTIVITIES.
 - IF LOCATED WITHIN LIMITS OF SYNTHETIC TURF INFIELD, ABANDON IN PLACE.
 - IF LOCATED WITHIN LIMITS OF SOD TRANSITION STRIP, FLAG EXPOSURE FOR OWNER'S ATTENTION. OWNER TO DECIDE UPON EXPOSURE.
3. FIELD VERIFY LOCATION AND ELEVATION OF EXISTING ELECTRIC LINES PRIOR TO ANY EARTHWORK ACTIVITIES AND PROTECT DURING CONSTRUCTION.
4. SEE SHEET C-7 FOR SITE FENCING REMOVALS.
5. REMOVE SAFETY NET POST.
6. REMOVE OLD STONE WALL FOUNDATION TO A POINT 2' BELOW SUBGRADE OR BOTTOM OF TURF ATTACHMENT CURB (208 LF).

DEMOLITION NOTES

THE CONTRACTOR IS RESPONSIBLE FOR THE DEMOLITION, REMOVAL, AND DISPOSAL AT A LOCATION APPROVED (BY ALL GOVERNING AUTHORITIES) OF ALL STRUCTURES, PADS, WALLS, FLUMES, FOUNDATIONS, PAVEMENTS, DRIVES, DRAINAGE STRUCTURES, UTILITIES, ETC., SUCH THAT THE IMPROVEMENTS SHOWN ON THE REMAINING PLANS CAN BE CONSTRUCTED. ALL FACILITIES TO BE REMOVED SHALL BE UNDERCUT TO SUITABLE MATERIAL AND BROUGHT TO GRADE WITH SUITABLY COMPACTED GRANULAR BACKFILL MATERIAL PER THE SPECIFICATIONS.

THE CONTRACTOR IS RESPONSIBLE FOR REMOVING ALL DEBRIS FROM THE SITE AND DISPOSING THE DEBRIS IN A LAWFUL MANNER.

THE CONTRACTOR IS RESPONSIBLE FOR OBTAINING ALL PERMITS REQUIRED FOR DEMOLITION, SITE CLEARING, AND DISPOSAL.

THE CONTRACTOR SHALL COORDINATE WITH RESPECTIVE UTILITY COMPANIES PRIOR TO THE REMOVAL AND/OR RELOCATION OF UTILITIES. THE CONTRACTOR SHALL COORDINATE WITH THE UTILITY COMPANY CONCERNING PORTIONS OF WORK WHICH MAY BE PERFORMED BY THE UTILITY COMPANY'S FORCES AND ANY FEES WHICH ARE TO BE PAID TO THE UTILITY COMPANY FOR THEIR SERVICES. THE CONTRACTOR IS RESPONSIBLE FOR PAYING ALL FEES AND CHARGES.

THE LOCATIONS OF ALL EXISTING UTILITIES SHOWN ON THIS PLAN HAVE BEEN DETERMINED FROM THE BEST INFORMATION AVAILABLE AND ARE GIVEN FOR THE CONVENIENCE OF THE CONTRACTOR. THE LAND SURVEYOR AND ENGINEER OF RECORD ASSUME NO RESPONSIBILITY FOR THEIR ACCURACY. PRIOR TO THE START OF ANY DEMOLITION ACTIVITY, THE CONTRACTOR SHALL NOTIFY THE UTILITY COMPANIES FOR ON-SITE LOCATIONS OF EXISTING UTILITIES.

ALL EXISTING SEWERS, PIPING, AND UTILITIES SHOWN ARE NOT TO BE INTERPRETED AS THE EXACT LOCATION OR AS THE ONLY OBSTACLES THAT MAY OCCUR ON THE SITE. VERIFY EXISTING CONDITIONS AND PROCEED WITH CAUTION AROUND ANY ANTICIPATED FEATURES. GIVE NOTICE TO ALL UTILITY COMPANIES REGARDING DESTRUCTION AND REMOVAL OF ALL SERVICE LINES AND CAP ALL LINES BEFORE PROCEEDING WITH THE WORK.

ELECTRICAL, TELEPHONE, CABLE, WATER, FIBER OPTIC CABLE, AND/OR GAS LINES NEEDING TO BE REMOVED OR RELOCATED SHALL BE COORDINATED WITH THE AFFECTED UTILITY COMPANY. ADEQUATE TIME SHALL BE PROVIDED FOR RELOCATION AND CLOSE COORDINATION WITH THE UTILITY COMPANY IS NECESSARY TO PROVIDE A SMOOTH TRANSITION IN UTILITY SERVICE.

IT SHALL BE THE RESPONSIBILITY OF THE CONTRACTOR TO CALL DIGGERS HOTLINE AT 1-800-242-8511 A MINIMUM OF 3 WORKING DAYS PRIOR TO EXCAVATION ACTIVITIES TO LOCATE AND MARK ALL UNDERGROUND UTILITIES.

IT SHALL BE THE RESPONSIBILITY OF THE CONTRACTOR TO HIRE A PRIVATE UTILITY LOCATING SERVICE TO LOCATE AND MARK ALL UNDERGROUND PRIVATE UTILITIES.

CONTRACTOR MUST PROTECT THE PUBLIC AT ALL TIMES WITH SIGNS, FENCING, BARRICADES, ENCLOSURES, ETC., (AND OTHER APPROPRIATE BEST MANAGEMENT PRACTICES) AS APPROVED BY THE CONSTRUCTION MANAGER. TEMPORARY CLOSURE OF ANY PUBLIC ROADWAY OR SIDEWALK SHALL BE APPROVED BY THE AUTHORITY HAVING JURISDICTION.

CONTINUOUS ACCESS SHALL BE MAINTAINED FOR THE SURROUNDING PROPERTIES AT ALL TIMES DURING THE COURSE OF WORK.

PRIOR TO DEMOLITION OCCURRING, ALL EROSION CONTROL DEVICES ARE TO BE INSTALLED.

EXISTING ITEMS TO REMAIN INCLUDING, BUT NOT LIMITED TO, FENCES, SIGNS, UTILITIES, BUILDINGS, TREES, PAVEMENTS, AND LIGHT POLES SHALL BE CAREFULLY PROTECTED DURING THE DEMOLITION PROCESS. ANY DAMAGE SUSTAINED TO ITEMS TO REMAIN IN PLACE SHALL BE REPAIRED OR REPLACED AT THE CONTRACTOR'S EXPENSE AT NO ADDITIONAL COST TO THE OWNER.

PROPERTY CORNERS AND BENCHMARKS SHALL BE CAREFULLY PROTECTED UNTIL THEY HAVE BEEN REFERENCED BY A PROFESSIONAL LAND SURVEYOR. PROPERTY MONUMENTS DISTURBED BY THE CONTRACTOR'S OPERATIONS SHALL BE REPLACED AT THE CONTRACTOR'S EXPENSE AT NO ADDITIONAL COST TO THE OWNER.

CONTRACTOR SHALL LIMIT PAVEMENT REMOVALS TO ONLY THOSE AREAS WHERE IT IS NECESSARY AS SHOWN ON THESE CONSTRUCTION PLANS. CONCRETE SIDEWALK AND CURB & GUTTER IS TO BE REMOVED TO NEAREST JOINT IN ORDER TO ACCOMMODATE PROPOSED IMPROVEMENTS. IF ANY DAMAGE IS INCURRED ON ANY OF THE SURROUNDING PAVEMENTS AND/OR OTHER IMPROVEMENTS, THE CONTRACTOR SHALL BE RESPONSIBLE FOR REMOVAL AND REPAIR OF DAMAGED PAVEMENT AND OTHER ITEMS AT NO ADDITIONAL COST TO THE OWNER.

CONTRACTOR TO REMOVE ALL EXISTING SIGNS WITHIN PROPERTY LIMITS EXCEPT FOR THOSE CALLED TO BE SALVAGED TO THE OWNER OR SALVAGED AND RELOCATED.

IF PREVIOUSLY UNIDENTIFIED HAZARDOUS, CONTAMINATED MATERIALS, OR OTHER ENVIRONMENTAL RELATED CONDITIONS ARE DISCOVERED, STOP WORK IMMEDIATELY AND NOTIFY THE PROJECT CONSTRUCTION MANAGER FOR ACTION TO BE TAKEN. DO NOT RESUME WORK UNTIL SPECIFICALLY AUTHORIZED BY THE CONSTRUCTION MANAGER.

AT THE COMPLETION OF THE PROJECT, THE CONTRACTOR SHALL REMOVE AND DISPOSE OF ALL ABANDONED, EXCESS, WASTE, STOCKPILED AND SPOIL MATERIAL IN ACCORDANCE WITH SECTION 205.3.12 OF THE "STATE SPECIFICATIONS". THIS WORK SHALL BE DONE AT THE CONTRACTOR'S EXPENSE.

EXISTING UTILITY DATA

STM 1 RIM 632.73 IE. 12° SE 627.33 IE. 8° S 627.43 IE. 12° WNW 626.78 IE. 12° ENE 629.13 IE. 21° E 623.73 IE. 21° N 623.73	STM 3 RIM 635.80 IE. 12° SSE 630.55 IE. 12° SW 629.45 IE. 12° NW 629.95 IE. 12° NE 630.25 IE. 24° S 628.95
STM 2 RIM 633.82 IE. 6° SW 629.72 IE. 8° E 629.22 IE. 8° N 629.17	CB 1 RIM 633.07 IE. 8° E 630.77
	CB 5 RIM 634.70 IE. 12° NNW 631.10

ALL ELEVATIONS REFER TO NATIONAL GEODETIC DATUM OF 1929.

- LEGEND:
- ⊕ STORM MANHOLE
 - CATCH BASIN
 - STM — STORM SEWER
 - DOWNSPOUT
 - ⊗ GAS METER

DIGGERS HOTLINE
Call 800 or (800) 242-8511
www.DiggersHotline.com

- ⊠ SKN
- X— FENCE
- PAD MOUNT TRANSFORMER
- ⊗ ELECTRIC PEDESTAL
- ⊗ ELECTRIC METER

UTILITY NOTE

EXISTING UTILITIES ARE SHOWN FOR INFORMATIONAL PURPOSES ONLY AND ARE NOT GUARANTEED TO BE ACCURATE OR ALL INCLUSIVE. CONTRACTOR IS RESPONSIBLE FOR VERIFYING THE TYPE, LOCATION, SIZE AND ELEVATION OF UNDERGROUND UTILITIES AS THEY DEEM NECESSARY FOR PROPOSED UTILITY CONNECTIONS AND / OR TO AVOID DAMAGE THERETO, CONTRACTOR SHALL CALL "DIGGERS HOTLINE" PRIOR TO ANY CONSTRUCTION.

- COMMUNICATION BOX
- ⊗ LIGHT POLE
- ⊗ POWER POLE
- O— OVERHEAD WIRES
- ⊗ DECIDUOUS TREE
- ⊗ 2" DIA COLUMN
- ⊗ 4" DIA POLE
- ⊗ 1.5" DIA POLE
- ⊗ GUARD POST

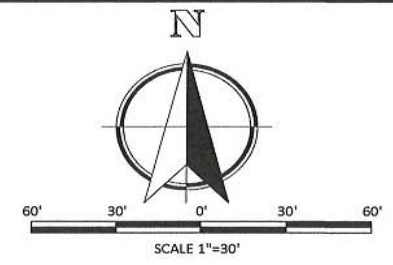

mb
Nielsen Madsen + Barber
CIVIL ENGINEERS AND LAND SURVEYORS
1458 Horizon Blvd. Suite 200, Racine, WI. 53406
Tele: (262)634-5588 Website: www.nmbcsc.net

HORLICK ATHLETIC FIELD
FOR
SITE DEMOLITION PLAN
FOR
RACINE PARKS DEPARTMENT
CITY OF RACINE, RACINE COUNTY, WISCONSIN

NO.	REVISION	BY	DATE

PROJ. MGR: _____ MDE
DRAFTED: _____ JEG
DATE: 9-11-2018
CHECKED: _____ ALJ
DATE: 9-11-2018

2018.0021.01
SHEET
C-4

ISSUE FOR BIDS: 9-11-2018

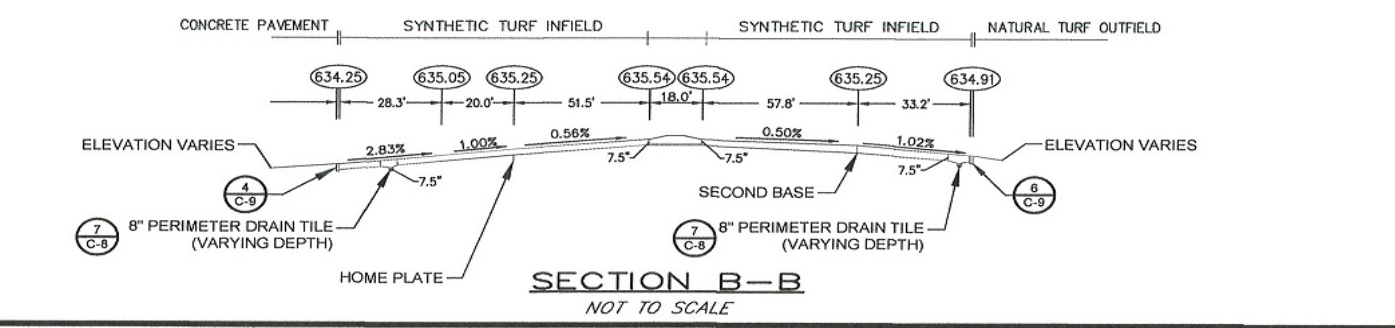
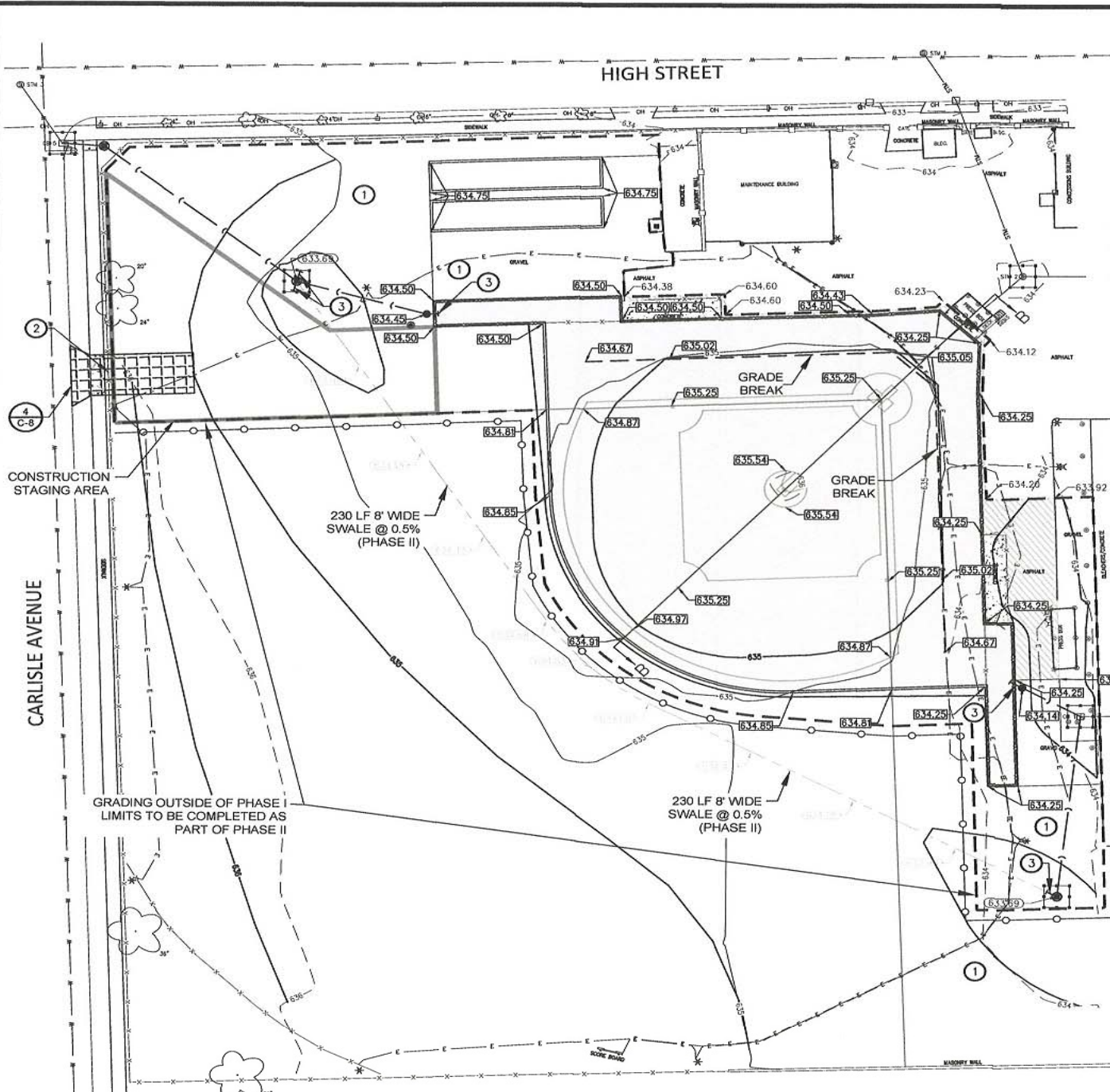

SITE GRADING & EROSION CONTROL LEGEND

- 692 — EXISTING CONTOURS
- 702 — PROPOSED CONTOURS
- - - DRAINAGE SWALE CENTERLINE
- 804.85 — EXISTING SPOT GRADES
- 804.85 — FINISHED GRADES
- 804.85 — FINISHED SWALE GRADES
- — LIMITS OF DISTURBANCE (1.75 ACRES)
- — STORM INLET PROTECTION
- — GRAVEL TRACKING PAD
- — EXCAVATE INFIELD TO DESIGN SUBGRADE AND PREPARE FOR SYNTHETIC TURF INSTALLATION

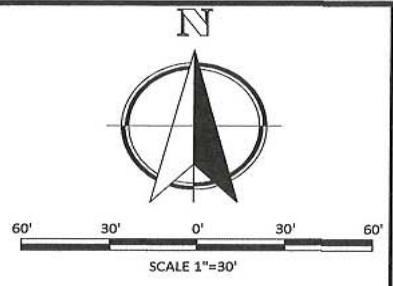

- ### NOTES
- CONTRACTOR TO GRADE AREA TO DRAIN TO PROPOSED DRAIN BASIN.
 - CONTRACTOR TO INSTALL TEMPORARY, LOCKABLE CONSTRUCTION GATE IN EXISTING FENCE AND RETURN FENCING, SIDEWALKS, PARKWAY, CURBS AND PAVEMENTS TO EXISTING CONDITIONS WHEN THE PROJECT IS COMPLETE.
 - EXCAVATION/UTILITY CONTRACTOR TO INSTALL STORM SEWER STUBS FOR THE UNDERDRAIN CONNECTION.

REFERENCES

EROSION CONTROL, EARTHWORK, SITE GRADING AND PAVEMENTS SHALL BE CONSTRUCTED IN ACCORDANCE WITH THE "STATE OF WISCONSIN, STANDARD SPECIFICATIONS FOR HIGHWAY AND STRUCTURE CONSTRUCTION", CURRENT EDITION, HEREIN REFERRED TO AS THE "STATE SPECIFICATIONS".

EROSION & SEDIMENT CONTROL NOTES

THE EROSION AND SEDIMENT CONTROL PROVISIONS DETAILED ON THE DRAWINGS AND SPECIFIED HEREIN ARE THE MINIMUM REQUIREMENTS FOR EROSION CONTROL.

PRIOR TO CONSTRUCTION, THE CONTRACTOR SHALL PREPARE ANY REVISIONS, ADJUSTMENTS OR PROPOSED ALTERATIONS TO THE CONSTRUCTION SEQUENCING AND/OR EROSION CONTROL PLANS. THE CONTRACTOR IS RESPONSIBLE TO NOTIFY ENGINEER OF RECORD AND REGULATORY OFFICIALS OF ANY CHANGES TO THE EROSION CONTROL AND STORMWATER MANAGEMENT PLANS. MODIFICATIONS TO THE APPROVED EROSION CONTROL DESIGN IN ORDER TO MEET UNFORESEEN FIELD CONDITIONS IS ALLOWED IF MODIFICATIONS CONFORM TO BEST MANAGEMENT PRACTICES (BMP'S). ALL SIGNIFICANT DEVIATIONS FROM THE PLANS MUST BE SUBMITTED AND APPROVED BY THE CITY OF RACINE.

THE CONTRACTOR IS RESPONSIBLE FOR INSTALLATION, MAINTENANCE, REPAIR AND REMOVAL OF ALL EROSION CONTROL DEVICES REQUIRED FOR THE PROJECT WHICH SHALL BE DONE IN ACCORDANCE WITH THE WISCONSIN DEPARTMENT OF NATURAL RESOURCES (DNR) TECHNICAL STANDARDS (REFERRED TO AS BMP'S) AND CITY OF RACINE ORDINANCES. THE CONTRACTOR SHALL BE RESPONSIBLE FOR ANY ADDITIONAL CONTROL MEASURES WHICH MAY BE NECESSARY TO MEET UNFORESEEN FIELD CONDITIONS. SEE CITY OF RACINE AND WDNR EROSION CONTROL PERMITS FOR ADDITIONAL DETAILS OR REQUIREMENTS.

ALL EROSION AND SEDIMENT CONTROL MEASURES AND DEVICES SHALL BE INSPECTED BY THE CONTRACTOR AS REQUIRED IN THE WISCONSIN ADMINISTRATIVE CODE (SPS 360.21) AND MAINTAINED PER SPS 360.22.

INSPECTIONS AND MAINTENANCE OF ALL EROSION CONTROL MEASURES SHALL BE ROUTINE (ONCE PER WEEK MINIMUM) TO ENSURE PROPER FUNCTION OF EROSION CONTROLS AT ALL TIMES. SEDIMENT AND EROSION CONTROL MEASURES ARE TO BE IN WORKING ORDER AT THE END OF EACH WORK DAY. THE CONTRACTOR SHALL CHECK THE EROSION AND SEDIMENT CONTROL PRACTICES FOR MAINTENANCE NEEDS AT ALL THE FOLLOWING INTERVALS UNTIL THE SITE IS STABILIZED:

- AT LEAST WEEKLY.
- WITHIN 24 HOURS AFTER A RAINFALL EVENT OF 0.5 INCHES OR GREATER. A RAINFALL EVENT SHALL BE CONSIDERED TO BE THE TOTAL AMOUNT OF RAINFALL RECORDED IN ANY CONTINUOUS 24-HOUR PERIOD. ALL EROSION AND SEDIMENT CONTROL ITEMS SHALL BE INSPECTED WITHIN 24 HOURS OF ALL RAIN EVENTS EXCEEDING 0.5 INCHES IMMEDIATELY REPAIR ANY DAMAGE OBSERVED DURING THE INSPECTION.

THE CONTRACTOR SHALL MAINTAIN A MONITORING RECORD WHEN THE LAND DISTURBING CONSTRUCTION ACTIVITY INVOLVES ONE OR MORE ACRES. THE MONITORING RECORD SHALL CONTAIN AT LEAST THE FOLLOWING INFORMATION:

- THE CONDITION OF THE EROSION AND SEDIMENT CONTROL PRACTICES AT THE INTERVALS SPECIFIED ABOVE.
- A DESCRIPTION OF THE MAINTENANCE CONDUCTED TO REPAIR OR REPLACE EROSION AND SEDIMENT CONTROL PRACTICES. EROSION AND SEDIMENT CONTROL INSPECTIONS AND ENFORCEMENT ACTIONS MAY BE CONDUCTED BY WDNR, THE CITY OF RACINE OR THEIR AUTHORIZED AGENTS DURING AND AFTER THE CONSTRUCTION OF THIS PROJECT.

EROSION AND SEDIMENT CONTROL INSPECTIONS AND ENFORCEMENT ACTIONS MAY BE CONDUCTED BY WDNR, THE CITY OF RACINE OR THEIR AUTHORIZED AGENTS DURING AND AFTER THE CONSTRUCTION OF THIS PROJECT. ADDITIONAL EROSION CONTROL MEASURES, AS REQUESTED BY STATE OR LOCAL INSPECTORS AND/OR THE ENGINEER OF RECORD, SHALL BE INSTALLED WITHIN 24 HOURS OF REQUEST.

ALL SEDIMENT AND EROSION CONTROL DEVICES, INCLUDING PERIMETER EROSION CONTROL MEASURES SUCH AS CONSTRUCTION ENTRANCES, SILT FENCE AND EXISTING INLET PROTECTION SHALL BE INSTALLED PRIOR TO COMMENCING EARTH DISTURBING ACTIVITIES. THE CONTRACTOR SHALL MAINTAIN ALL EROSION CONTROL DEVICES UNTIL THE SITE HAS ESTABLISHED A VEGETATIVE COVER AND IS STABILIZED.

ALL PROPOSED STORM SEWER STRUCTURES AND ADJACENT EXISTING STORM INLETS SHALL HAVE A LAYER OF GEOTEXTILE FABRIC (TYPE "FF") INSTALLED BETWEEN THE FRAME & GRATE TO PREVENT SEDIMENT OR SILT FROM ENTERING THE SYSTEM. THE INLET PROTECTION SHALL BE INSPECTED BY THE CONTRACTOR AND REPLACED EVERY 14 DAYS AND AFTER EACH RAINFALL EVENT. FABRIC TO BE REPLACED AS NEEDED TO MEET FIELD CONDITIONS.

THE CONTRACTOR IS RESPONSIBLE FOR CONTROLLING WIND EROSION (DUST) DURING CONSTRUCTION AT HIS/HER EXPENSE (WHEN NECESSARY OR AS REQUIRED BY LOCAL INSPECTORS AND/OR ENGINEER OF RECORD).

EROSION CONTROL FOR UTILITY CONSTRUCTION (STORM SEWER):

- PLACE EXCAVATED TRENCH MATERIAL ON THE HIGH SIDE OF THE TRENCH.
- BACKFILL, COMPACT AND STABILIZE THE TRENCH IMMEDIATELY AFTER PIPE CONSTRUCTION.
- ANY WATER PUMPED FROM PITS, TRENCHES, WELLS OR PONDS SHALL BE DISCHARGED INTO A SEDIMENTATION BASIN OR FILTERING TANK IN ACCORDANCE WITH WDNR TECHNICAL STANDARD 1081 AND BMP'S PRIOR TO RELEASE INTO THE STORM SEWER, RECEIVING STREAM OR DRAINAGE DITCH. PUMPED WATER CAN BE TREATED IN FILTER BAGS, STONE FILTERS OR SIMILAR DEVICES. QUALITY OF PUMPED WATER SHALL BE CONTINUOUSLY MONITORED DURING PUMPING OPERATIONS.

CONSTRUCTION ENTRANCES SHALL BE INSTALLED AT ALL LOCATIONS OF VEHICLE INGRESS/EGRESS POINTS. CONTRACTOR IS RESPONSIBLE TO COORDINATE LOCATION(S) WITH THE PROPER AUTHORITIES, PROVIDE NECESSARY FEES AND OBTAIN ALL REQUIRED APPROVALS OR PERMITS. ADDITIONAL CONSTRUCTION ENTRANCES, OTHER THAN SHOWN ON THE PLANS, MUST HAVE PRIOR APPROVAL BY THE CITY OF RACINE.

ALL EXPOSED SOIL AREAS THAT WILL NOT BE BROUGHT TO FINAL GRADE OR ON WHICH LAND DISTURBING ACTIVITIES WILL NOT BE PERFORMED FOR A PERIOD GREATER THAN 14 DAYS AND REQUIRE VEGETATIVE COVER FOR LESS THAN 1 YEAR, REQUIRE TEMPORARY SEEDING FOR EROSION CONTROL. SEEDING FOR EROSION CONTROL SHALL BE IN ACCORDANCE WITH WDNR TECHNICAL STANDARD 1059 AND CITY OF RACINE ORDINANCE.

PAVED SURFACES ADJACENT TO CONSTRUCTION SITE VEHICLE ACCESS SHALL BE SWEEPED AND/OR SCRAPPED TO REMOVE ACCUMULATED SOIL, DIRT AND/OR DUST AT THE END OF EACH WORK DAY AND AS REQUESTED BY THE CITY OF RACINE.

EROSION CONTROL MEASURES SHALL BE REMOVED ONLY AFTER SITE CONSTRUCTION IS COMPLETE WITH ALL SOIL SURFACES HAVING AN ESTABLISHED VEGETATIVE COVER.

SITE GRADING & SUB-GRADE PREPARATION

EXCAVATE, GRADE & SHAPE SUBGRADES TO THE LINES AND GRADES SHOWN ON THE PLANS. SEE TYPICAL SECTIONS AND CONSTRUCTION DETAILS FOR PAVEMENT THICKNESS AND MATERIALS.

UPON COMPLETION OF THE GRADING AND COMPACTION OF THE SUBGRADE, A PROOF ROLL SHALL BE CONDUCTED BY THE CONTRACTOR ON ALL SUBGRADES TO RECEIVE DENSE AGGREGATE BASE COURSE. THE CONTRACTOR SHALL PROVIDE A FULLY LOADED QUAD-AXLE TRUCK (18 TON MINIMUM LOAD) TO PERFORM THE PROOF ROLL. CONTRACTOR SHALL COORDINATE THE PROOF ROLL WITH THE OWNER OR HIS REPRESENTATIVES TO ENSURE THEY ARE PRESENT. SOFT AREAS, IF DISCOVERED, SHALL BE EXCAVATED TO REMOVE THE UNSUITABLE MATERIAL, BACKFILLED WITH COMPACTED STRUCTURAL MATERIAL AND RETESTED TO ENSURE THEY HAVE BEEN REPAIRED.

AT THE COMPLETION OF THE PROJECT THE CONTRACTOR SHALL REMOVE AND DISPOSE OF ALL ABANDONED, EXCESS, WASTE, STOCKPILED AND SPOIL MATERIAL IN ACCORDANCE WITH SECTION 205.3.12 OF THE "STATE SPECIFICATIONS". THIS WORK SHALL BE DONE AT THE CONTRACTOR'S EXPENSE.

UTILITY NOTE

EXISTING UTILITIES ARE SHOWN FOR INFORMATIONAL PURPOSES ONLY AND ARE NOT GUARANTEED TO BE ACCURATE OR ALL INCLUSIVE. CONTRACTOR IS RESPONSIBLE FOR VERIFYING THE TYPE, LOCATION, SIZE AND ELEVATION OF UNDERGROUND UTILITIES AS THEY DEEM NECESSARY FOR PROPOSED UTILITY CONNECTIONS AND / OR TO AVOID DAMAGE THERETO, CONTRACTOR SHALL CALL "DIGGERS HOTLINE" PRIOR TO ANY CONSTRUCTION.

DIGGERS HOTLINE
Call (800) 242-8511
www.DiggersHotline.com

ALL ELEVATIONS REFER TO NATIONAL GEODEIC DATUM OF 1929.

LEGEND:

⊙	STORM MANHOLE	■	PAD MOUNT TRANSFORMER	⊕	DECIDUOUS TREE
□	CATCH BASIN	⊗	ELECTRIC PEDESTAL	⊙	2" DIA COLUMN
— STM —	STORM SEWER	⊠	ELECTRIC METER	○	4" DIA POLE
●	DOWNSPOUT	⊠	COMMUNICATION BOX	⊙	1.5" DIA POLE
⊠	GAS METER	⊠	LIGHT POLE	⊙	GUARD POST
⊠	SIGN	⊠	POWER POLE		
— X —	FENCE	— OH —	OVERHEAD WIRES		

HORLICK ATHLETIC FIELD
SITE GRADING & EROSION CONTROL PLAN
FOR
RACINE PARKS DEPARTMENT
CITY OF RACINE, RACINE COUNTY, WISCONSIN

NO.	REVISION	DATE

PROJ. MGR: MDE
DRAFTED: JEG
DATE: 9-11-2018
CHECKED: ALU
DATE: 9-11-2018
2018.0021.01
SHEET
C-5

ISSUE FOR BIDS: 9-11-2018



Nielsen Madsen + Barber
 CIVIL ENGINEERS AND LAND SURVEYORS
 1458 Horizon Blvd. Suite 200, Racine, WI. 53406
 Tele: (262)634-5588 Website: www.nmbssc.net

**HORLICK ATHLETIC FIELD
 STORM SEWER / UNDERDRAIN PLAN
 FOR
 RACINE PARKS DEPARTMENT**
 CITY OF RACINE, RACINE COUNTY, WISCONSIN

NO.	REVISION	BY	DATE

PROJ. MGR: MDE
 DRAFTED: JEG
 DATE: 9-11-2018
 CHECKED: ALL
 DATE: 9-11-2018
 SHEET
C-6

ISSUE FOR BIDS: 9-11-2018

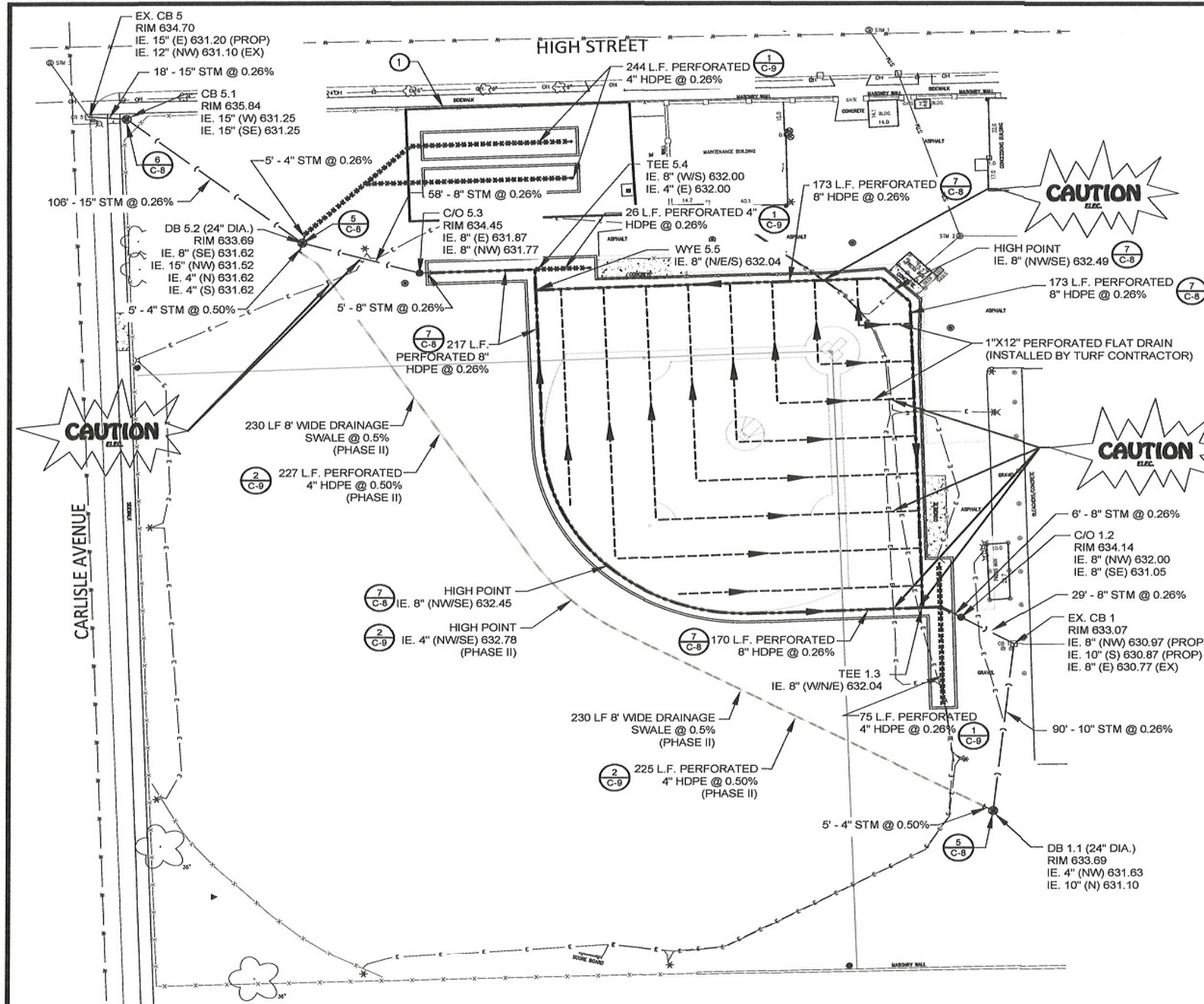

SCALE 1"=30'

SYNTHETIC TURF SUB-SURFACE DRAINAGE NOTES

- MATERIALS AND CONSTRUCTION METHODS FOR THE ARTIFICIAL TURF SUBSURFACE DRAINAGE SYSTEM SHALL BE IN ACCORDANCE WITH SECTION 607 OF THE "STATE SPECIFICATIONS" EXCEPT AS MODIFIED HEREIN.
 - A. 8" PERFORATED PERIMETER DRAIN TILES AND 4" TURF UNDERDRAIN PIPE MATERIAL SHALL BE STATE OF WISCONSIN DEPARTMENT OF SAFETY AND PROFESSIONAL SERVICES (DPS) APPROVED MATERIALS MEETING THE FOLLOWING REQUIREMENTS:
 - I. DRAIN TILE SHALL BE IN ACCORDANCE WITH AASHTO DESIGNATION M294-M TYPE "CP" FOR CORRUGATED HDPE SEWER PIPE AS PRODUCED BY ADVANCED DRAINAGE SYSTEMS (ADS), INC. OR APPROVED EQUAL AND FURNISHED WITH STANDARD PIPE PERFORATIONS (CONFIGURATION "E").
- STONE BEDDING, BACKFILL AND COVER MATERIAL FOR THE PERIMETER DRAIN TILE AND TURF UNDERDRAIN PIPE SHALL BE 3/4" CLEAR CRUSHED STONE CHIPS IN ACCORDANCE WITH TABLE 33, CHAPTER 8.43.2 OF THE "STANDARD SPECIFICATIONS".
 - A. AS-BUILT "RECORD DRAWINGS" OF THE COMPLETED SUB-GRADE(S) SHALL BE PROVIDED PRIOR TO PLACEMENT OF THE SYNTHETIC TURF DRAINAGE AGGREGATE.

SYNTHETIC TURF SUB-GRADE PREPARATION NOTES

- THE SUB-GRADE SHALL HAVE A MINIMUM SLOPE OF 0.5% (OR MORE) AND BE COMPACTED IN ALL DIRECTIONS TO ATTAIN THE SPECIFIED COMPACTION RATE OF 95% OF THE STANDARD PROCTOR MAXIMUM DENSITY.
- THE SUB-GRADE MUST BE PREPARED TO TOLERANCES OF NOT MORE THAN 1/2" FROM DESIGN GRADE (UNDER A 10' STRAIGHTEDGE IN ALL DIRECTIONS) TO ALLOW FOR EVEN DRAINAGE (FULLY AUTOMATED LASER GUIDED FINE GRADING IS MANDATORY).
 - A. AS-BUILT "RECORD DRAWINGS" OF THE COMPLETED SUB-GRADE(S) SHALL BE PROVIDED PRIOR TO PLACEMENT OF THE SYNTHETIC TURF DRAINAGE AGGREGATE.
- AFTER THE EXISTING SUB-GRADE HAS BEEN PROPERLY GRADED, CONTOURED AND SLOPED, IT SHALL BE COMPACTED USING A 10 TON VIBRATING ROLLER AND PROOF ROLLED TO PROVE STABILITY.

PERIMETER COLLECTOR DRAIN INSTALLATION NOTES

- PERIMETER COLLECTOR DRAIN TRENCHES SHALL BE A MINIMUM 16" WIDE WITH DEPTH & SLOPE PER PLAN.
- ALL DRAIN TILES 8" IN DIAMETER AND SMALLER SHALL BE AND INSTALLED WITH ADS "DRAIN GUARD" SYNTHETIC GEOTEXTILE PIPE WRAP MATERIAL (OR APPROVED EQUAL).
- CORRUGATED, PERFORATED HDPE COLLECTOR DRAINS SHALL BE INSTALLED IN CENTER OF TRENCHES.
 - A. USE MANUFACTURED FITTINGS FOR ALL CONNECTIONS INTO THE COLLECTOR DRAINAGE NETWORK.
- INSTALL A MINIMUM OF 2" CLEAN CRUSHED STONE CHIPS IN THE BOTTOM OF THE COLLECTOR DRAIN TRENCH AND BELOW SYNTHETIC TURF BEDDING SAND FABRIC.
- PLACE A MINIMUM OF 4" CLEAN CRUSHED STONE CHIPS ON THE SIDES OF THE UNDERDRAINS AND MAXIMUM OF 2" BELOW.
- PERIMETER COLLECTOR DRAIN TRENCH BACKFILL SHALL BE COMPACTED BY HAND TAMPING (OR EQUIVALENT) TO A MINIMUM 95% OF THE MAXIMUM DENSITY.

STORM SEWER SPECIFICATIONS

- STORM SEWER CONSTRUCTION SHALL BE COMPLETED IN ACCORDANCE WITH THE "STANDARD SPECIFICATIONS FOR SEWER & WATER CONSTRUCTION IN WISCONSIN", 6TH EDITION, DECEMBER 22, 2003 WITH ADDENDA NO. 1 AND NO. 2, HEREIN REFERRED TO AS THE "STANDARD SPECIFICATIONS".
- MATERIAL FOR STORM SEWERS AND ROOF DRAIN LATERALS AND DRAIN TILES SHALL BE IN ACCORDANCE WITH THE STATE OF WISCONSIN DEPARTMENT OF SAFETY AND PROFESSIONAL SERVICES (DPS) REGULATIONS.
- STORM SEWER PIPE MATERIALS SHALL CONFORM TO DPS 384.30 OF THE WISCONSIN ADMINISTRATIVE CODE. REINFORCED CONCRETE PIPE (RCP) AND POLYVINYL CHLORIDE (PVC) MATERIALS SHALL BE SELECTED FROM TABLE 84.30-6. CORRUGATED HIGH DENSITY POLYETHYLENE (HDPE) PIPE MATERIAL (IF SELECTED) SHALL MEET THE REQUIREMENTS OF AASHTO M-252 FOR 4"-10" DIAMETER SIZES AND AASHTO M294 FOR 12"-48" DIAMETER SIZES.
- BEDDING AND COVER MATERIAL SHALL BE SAND, CRUSHED STONE CHIPS OR CRUSHED STONE SCREENINGS CONFORMING TO CHAPTER 8.43.2 OF THE "STANDARD SPECIFICATIONS".
- ALL STORM SEWERS INSTALLED IN EXISTING OR PROPOSED PAVED AREAS SHALL BE BACKFILLED WITH COMPACTED GRANULAR MATERIAL IN ACCORDANCE WITH TABLE 37, CHAPTER 8.43.4 OF THE "STANDARD SPECIFICATIONS". BACKFILL MATERIAL SHALL BE PLACED IN 12" MAXIMUM LIFTS AND SHALL EXTEND A MINIMUM OF FIVE FEET (5') OUTSIDE OF THE PAVEMENT LIMITS. TRENCHES RUNNING PARALLEL TO AND LESS THAN FIVE FEET (5') FROM THE EDGE OF PAVEMENT SHALL ALSO REQUIRE COMPACTED GRANULAR BACKFILL.
- ALL STORM SEWERS INSTALLED IN LAWN AREAS SHALL BE BACKFILLED WITH SPOIL MATERIAL AND COMPACTED TO A DENSITY EQUAL TO 100% OF THE DENSITY OF THE UNDISTURBED MATERIAL IN THE ADJACENT TRENCH WALLS.
- A 10-GAUGE TRACER WIRE SHALL BE INSTALLED THE ENTIRE LENGTH OF ALL PRIVATE STORM SEWERS SYSTEMS (INCLUDING 8" PERFORATED DRAIN TILES) PER DPS 382.36(7)(d)10. THE TRACER WIRE SHALL BE EXTENDED TO THE SURFACE WITHIN ALL DRAINAGE STRUCTURES AND SHALL INCLUDE A MINIMUM OF 2' OF SLACK.
- ALL STORM SEWERS, MANHOLES, CATCH BASINS AND DRAIN BASINS SHALL BE CONSTRUCTED WITH WATER AND GAS TIGHT JOINTS IN CONFORMANCE WITH DPS 384.40.
- AT THE COMPLETION OF THE PROJECT THE CONTRACTOR SHALL REMOVE AND DISPOSE OF ALL ABANDONED, EXCESS, WASTE, STOCKPILED AND SPOIL MATERIAL IN ACCORDANCE WITH SECTION 205.3.12 OF THE "STATE SPECIFICATIONS". THIS WORK SHALL BE DONE AT THE CONTRACTOR'S EXPENSE.

NOTES

- EXCAVATION/UTILITY CONTRACTOR TO INSTALL STORM SEWER STUBS FOR THE UNDERDRAIN CONNECTION.
- ALL UNDERDRAINS TO BE INSTALLED BY THE TURF CONTRACTOR.

NOTES

- BATTING CAGES AND ALL ASSOCIATED PAVEMENTS, FENCING, STORM SEWER AND REMOVALS ARE PART OF ALTERNATE BID 1.

STORM SEWER / DRAIN TILE LEGEND

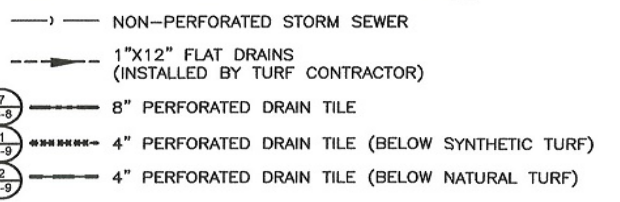

EXISTING UTILITY DATA

STM 1 RIM 632.73 IE. 12" SE 627.33 IE. 8" S 627.43 IE. 12" WNW 626.78 IE. 12" ENE 629.13 IE. 21" E 623.73 IE. 21" N 623.73	STM 3 RIM 635.90 IE. 12" SSE 630.55 IE. 12" SW 629.45 IE. 12" NW 629.95 IE. 12" NE 630.25 IE. 24" S 628.95
STM 2 RIM 633.82 IE. 6" SW 629.72 IE. 8" E 629.22 IE. 8" N 629.17	CB 1 RIM 633.07 IE. 8" (NW) 630.97 (PROP) IE. 10" (S) 630.87 (PROP) IE. 8" (E) 630.77 (EX)
	CB 5 RIM 634.70 IE. 12" NNW 631.10

ALL ELEVATIONS REFER TO NATIONAL GEODETIC DATUM OF 1929.

LEGEND:

- ⊕ STORM MANHOLE
- CATCH BASIN
- STM — STORM SEWER
- DOWNSPOUT
- ⊗ GAS METER
- ⊠ SIGN
- X — FENCE
- PAD MOUNT TRANSFORMER
- ⊗ ELECTRIC PEDESTAL
- ⊠ ELECTRIC METER
- ⊞ COMMUNICATION BOX
- ⊞ 2" DIA COLUMN
- ⊞ 4" DIA POLE
- ⊞ 1.5" DIA POLE
- ⊞ GUARD POST
- ⊗ LIGHT POLE
- ⊞ POWER POLE
- OH — OVERHEAD WIRES
- ⊗ DECIDUOUS TREE

DIGGERS HOTLINE
 Call (811) or (800) 242-8511
 www.DiggersHotline.com

UTILITY NOTE
 EXISTING UTILITIES ARE SHOWN FOR INFORMATIONAL PURPOSES ONLY AND ARE NOT GUARANTEED TO BE ACCURATE OR ALL INCLUSIVE. CONTRACTOR IS RESPONSIBLE FOR VERIFYING THE TYPE, LOCATION, SIZE AND ELEVATION OF UNDERGROUND UTILITIES AS THEY DEEM NECESSARY FOR PROPOSED UTILITY CONNECTIONS AND / OR TO AVOID DAMAGE THERETO, CONTRACTOR SHALL CALL "DIGGER'S HOTLINE" PRIOR TO ANY CONSTRUCTION.

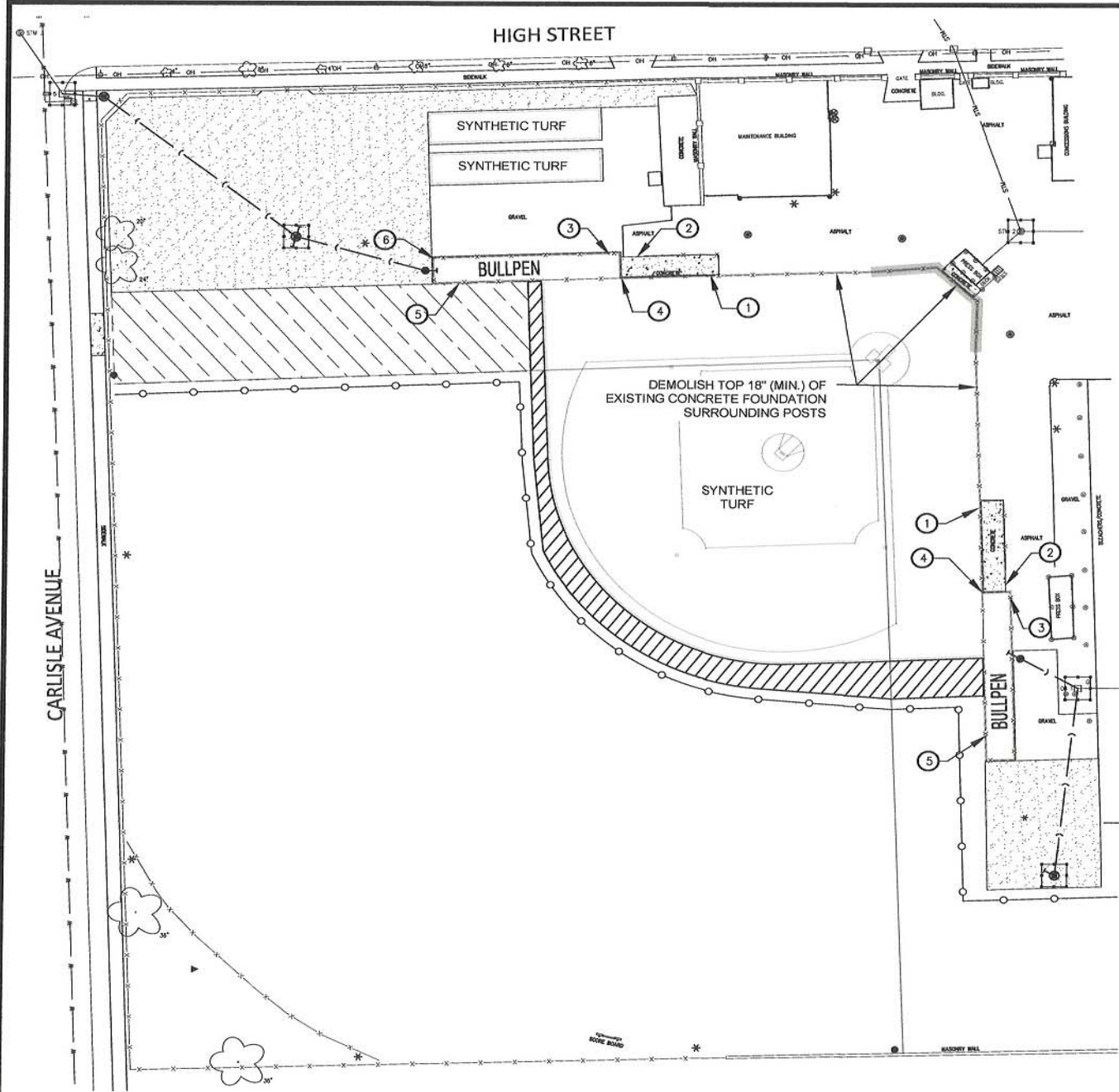

SITE RESTORATION LEGEND

- STORM INLET PROTECTION
- LAWN SEED MIX (40% BLUEGRASS MIX)
- SOD TRANSITION STRIP
- ATHLETIC SEED MIX (80% BLUEGRASS MIX)

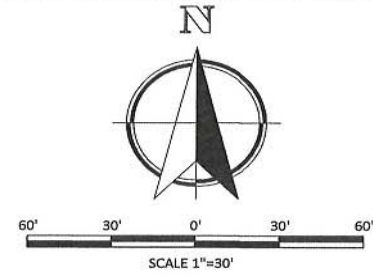

GENERAL NOTES

- (A)** ALL WORK TO BE DONE BY CONTRACTOR UNLESS OTHERWISE NOTED.
- (B)** CONTRACTOR SHALL FIELD VERIFY ALL DIMENSIONS AND ACCOUNT FOR ALL SITE CONDITIONS WHICH CAN BE REASONABLY OBSERVED BY SITE VISIT.

FENCING NOTES

- EXISTING BACKSTOP TO REMAIN IN PLACE. BOTTOM SUPPORT BARS AND LOWER FOUR FEET (4') OF THE FENCING FABRIC TO BE TEMPORARILY REMOVED TO ACCOMMODATE THE CONCRETE PAVEMENT AND ATTACHMENT CURB INSTALLATION AND REINSTALLED WITH NEW HARDWARE AS NECESSARY TO MATCH EXISTING.
- EXISTING FENCE POSTS AND FOUNDATIONS TO BE DEMOLISHED. EXISTING FENCE FABRIC TO BE REMOVED AND SALVAGED TO OWNER. INSTALL NEW 10' HIGH CHAIN-LINK FENCE WITH TOP, BOTTOM AND MIDDLE SUPPORTS.
- (1)** EXISTING FENCE OPENING TO FIELD (TO REMAIN)
- (2)** EXISTING FENCE OPENING TO DUGOUT (TO REMAIN)
- (3)** INSTALL 3'-0" W CHAIN LINK FENCE GATE
- (4)** INSTALL NEW 4" DIA X 15'-0" H CORNER POST
- (5)** ALL FENCE TO BE GALVANIZED CHAIN LINK FENCE UNLESS NOTED OTHERWISE (SEE SPECIFICATIONS FOR DETAILS)
- (6)** INSTALL 12" H X 6" DIA CORNER FENCE POST WITH FOUNDATION AND CAP TO SERVE AS NEW SAFETY NET POST. CABLES AND NETTING TO BE INSTALLED BY OTHERS.

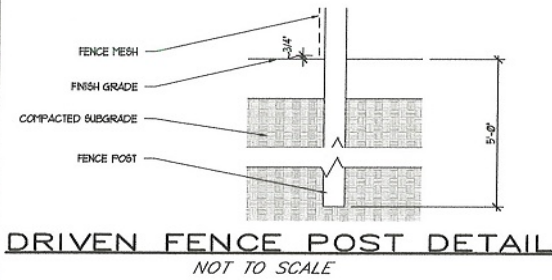

DRIVEN FENCE POST DETAIL
NOT TO SCALE

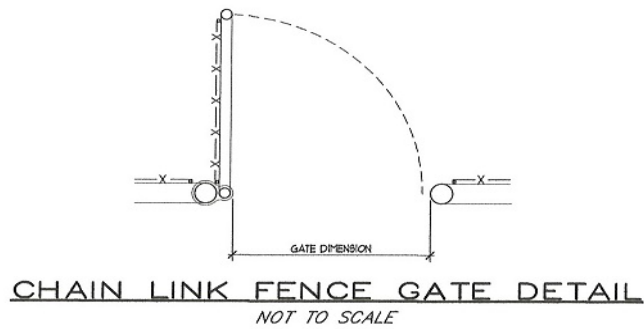

CHAIN LINK FENCE GATE DETAIL
NOT TO SCALE

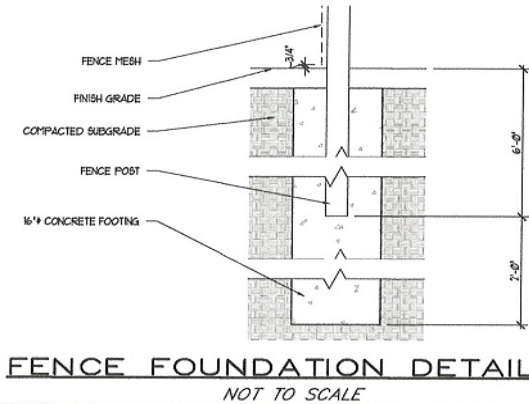

FENCE FOUNDATION DETAIL
NOT TO SCALE

ALL ELEVATIONS REFER TO NATIONAL GEODETIC DATUM OF 1929.

- LEGEND:**
- STORM MANHOLE
 - CATCH BASIN
 - STM — STORM SEWER
 - DOWNSPOUT
 - GAS METER

DIGGERS HOTLINE
Call **800** or **(800) 242-8511**
www.DiggersHotline.com

- SIGN
- X— FENCE
- PAD MOUNT TRANSFORMER
- ELECTRIC PEDESTAL
- ELECTRIC METER

UTILITY NOTE

EXISTING UTILITIES ARE SHOWN FOR INFORMATIONAL PURPOSES ONLY AND ARE NOT GUARANTEED TO BE ACCURATE OR ALL INCLUSIVE. CONTRACTOR IS RESPONSIBLE FOR VERIFYING THE TYPE, LOCATION, SIZE AND ELEVATION OF UNDERGROUND UTILITIES AS THEY DEEM NECESSARY FOR PROPOSED UTILITY CONNECTIONS AND / OR TO AVOID DAMAGE THERE TO. CONTRACTOR SHALL CALL "DIGGER'S HOTLINE" PRIOR TO ANY CONSTRUCTION.

- COMMUNICATION BOX
- LIGHT POLE
- POWER POLE
- OH— OVERHEAD WIRES
- DECIDUOUS TREE
- 2" DIA COLUMN
- 4" DIA POLE
- 1.5" DIA POLE
- GUARD POST



Nielsen Madsen + Barber
CIVIL ENGINEERS AND LAND SURVEYORS
1458 Horizon Blvd. Suite 200, Racine, WI. 53406
Tele: (262)634-5588 Website: www.nmbasc.net

HORLICK ATHLETIC FIELD
SITE FENCING & RESTORATION PLAN
FOR
RACINE PARKS DEPARTMENT
CITY OF RACINE, RACINE COUNTY, WISCONSIN

NO.	REVISION	BY	DATE

PROJ. MGR: _____ MDE
DRAFTED: _____ JEG
DATE: 9-11-2018
CHECKED: _____ ALJ
DATE: 9-11-2018

2018.0021.01
SHEET
C-7

ISSUE FOR BIDS: 9-11-2018

INSTALLATION NOTES

TYPE B & C
TRIM EXCESS FABRIC IN THE FLOW LINE TO WITHIN 3" OF THE GRATE.

THE CONTRACTOR SHALL DEMONSTRATE A METHOD OF MAINTENANCE, USING A SEWN FLAP, HAND HOLDS OR OTHER METHOD TO PREVENT ACCUMULATED SEDIMENT FROM ENTERING THE INLET.

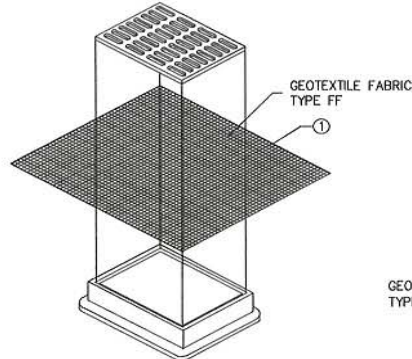

INLET PROTECTION, TYPE B (WITHOUT CURB BOX)
(CAN BE INSTALLED IN ANY INLET WITHOUT A CURB BOX)

1 TYPICAL STORMWATER INLET PROTECTION DETAIL
NOT TO SCALE

GENERAL NOTES

MANUFACTURED ALTERNATIVES APPROVED AND LISTED ON THE W DOT'S EROSION CONTROL PRODUCT ACCEPTABILITY LIST MAY BE SUBSTITUTED. WHEN REMOVING OR MAINTAINING INLET PROTECTION, CARE SHALL BE TAKEN SO THAT THE SEDIMENT TRAPPED ON THE GEOTEXTILE FABRIC DOES NOT FALL INTO THE INLET. ANY MATERIAL FALLING INTO THE INLET SHALL BE REMOVED IMMEDIATELY.

- FINISHED SIZE, INCLUDING FLAP POCKETS WHERE REQUIRED, SHALL EXTEND A MINIMUM OF 10" AROUND THE PERIMETER TO FACILITATE MAINTENANCE OR REMOVAL.
- FOR INLET PROTECTION, TYPE C (WITH CURB BOX), AN ADDITIONAL 18" OF FABRIC IS WRAPPED AROUND THE WOOD AND SECURED WITH STAPLES.
- THE WOOD SHALL NOT BLOCK THE ENTIRE HEIGHT OF THE CURB BOX OPENING. FLAP POCKETS SHALL BE LARGE ENOUGH TO ACCEPT WOOD 2X4.

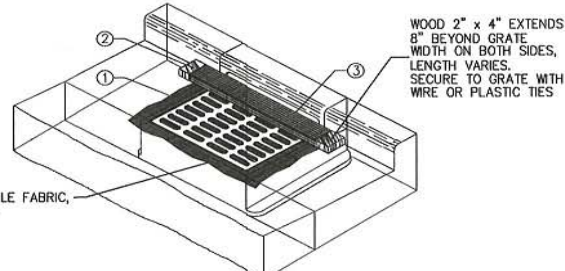

INLET PROTECTION, TYPE C (WITH CURB BOX)
(CAN BE INSTALLED IN ANY INLET WITH A CURB BOX)

- 14" PAVEMENT SECTION (TYPICAL)
- 4" HMA PAVEMENT, LT 58-28 S
 - 2" THICK UPPER COURSE (4 LT 58-28 S)
 - 2" THICK LOWER COURSE (4 LT 58-28 S)
- 10" COMPACTED DENSE AGGREGATE BASE
 - 1 1/4" GRADATION (PER SECTION 305.2.2.1 OF THE "STATE SPECIFICATIONS")

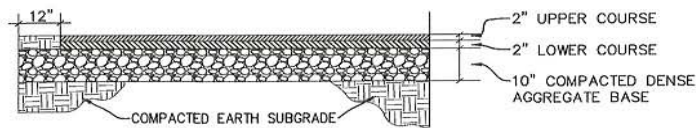

2 MEDIUM DUTY ASPHALT PAVEMENT (TYPICAL SECTION)
NOT TO SCALE

- 8" PAVEMENT SECTION (TYPICAL)
- 4" CONCRETE SIDEWALK (PER SECTION 415 OF THE "STATE SPECIFICATIONS")
 - ALL CONCRETE SHALL BE GRADE A-FA, AIR-ENTRAINED, 6-BAG MIX WITH A MINIMUM 28-DAY COMPRESSIVE STRENGTH OF 3,500 PSI.
- 4" COMPACTED DENSE AGGREGATE BASE
 - 3/4" GRADATION (PER SECTION 305.2.2.1 OF THE "STATE SPECIFICATIONS")
 - BASE COURSE SHALL EXTEND A MINIMUM OF 12 INCHES BEYOND THE EDGE OF CONCRETE.

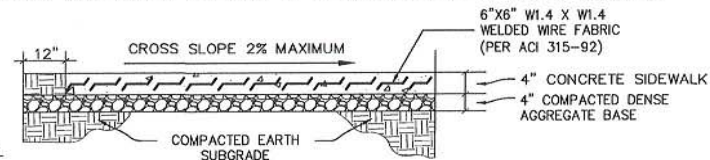

- NOTES:**
- PROVIDE CONTROL JOINTS AT AN INTERVAL MATCHING THE SIDEWALK WIDTH BUT NO GREATER THAN A 10'X10' GRID.
 - PROVIDE EXPANSION JOINTS AT INTERVAL NO GREATER THAN 100 LINEAR FEET. EXPANSION JOINT FILLER MATERIAL SHALL BE ONE PIECE FIBERBOARD OR THE APPROVED EQUIVALENT MATERIAL AND SHALL BE 1/2 INCH THICK.

3 LIGHT-DUTY CONCRETE PAVEMENT (TYPICAL SECTION)
NOT TO SCALE

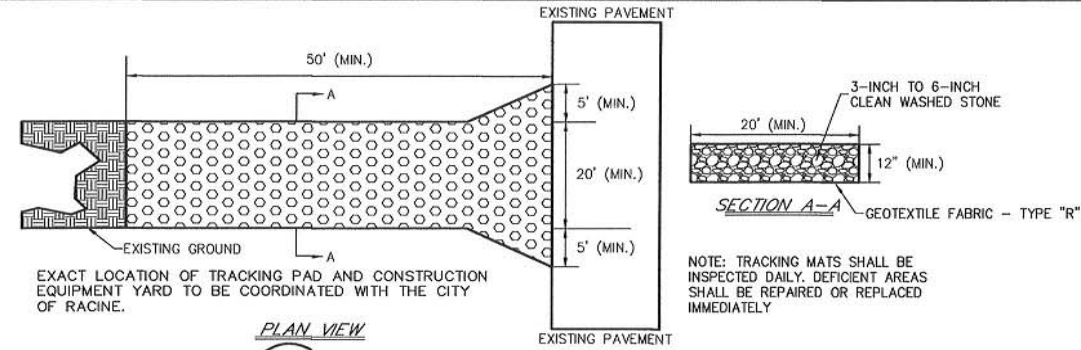

4 TRACKING PAD DETAIL
NOT TO SCALE

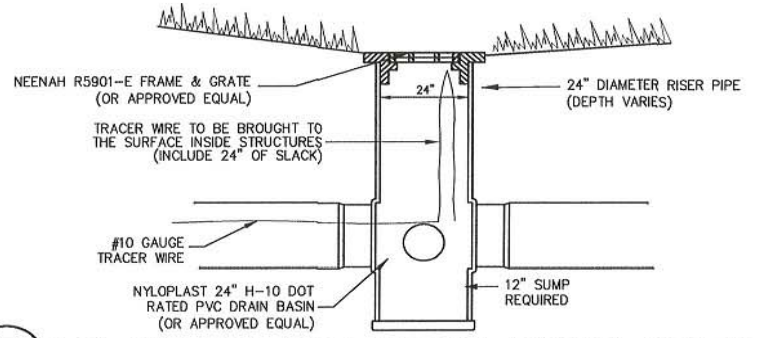

5 24" NYLOPLAST DRAIN BASIN DETAIL
NOT TO SCALE

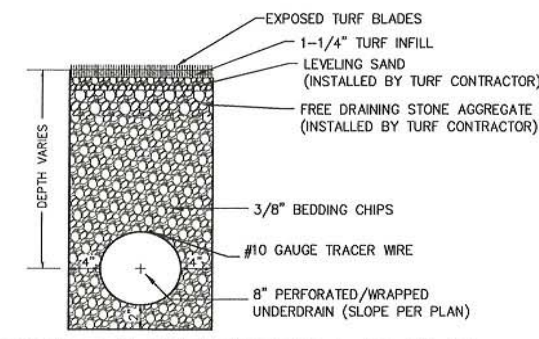

7 8" PIPE UNDERDRAIN DETAIL
NOT TO SCALE

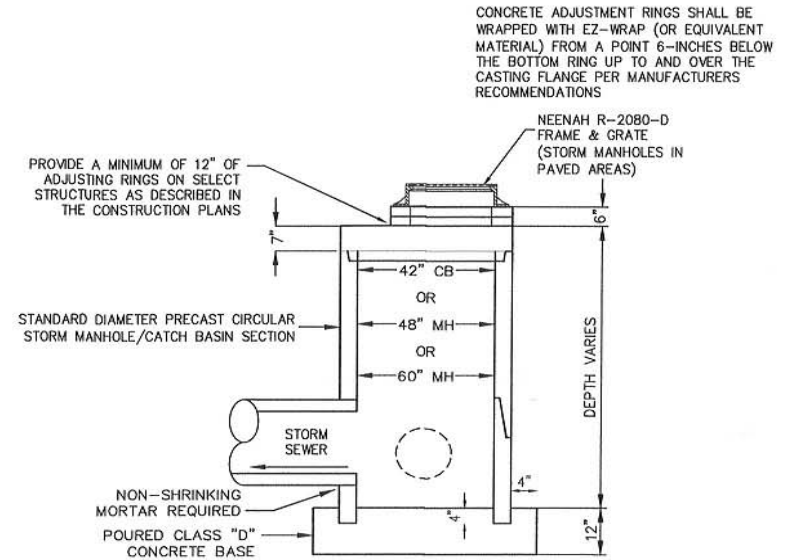

6 42"/48"/60" DIAMETER STORM MANHOLE/CATCH BASIN DETAIL
NOT TO SCALE

mb
Nielsen Madsen + Barber
CIVIL ENGINEERS AND LAND SURVEYORS
1458 Horizon Blvd, Suite 200, Racine, WI. 53406
Tele: (262)634-5588 Website: www.nmbssc.net

HORLICK ATHLETIC FIELD
FOR
TYPICAL SECTIONS & CONSTRUCTION DETAILS
FOR
RACINE PARKS DEPARTMENT
CITY OF RACINE, RACINE COUNTY, WISCONSIN

NO.	REVISION	BY	DATE

PROJ. MGR: MDE
DRAFTED: JEG
DATE: 9-11-2018
CHECKED: ALJ
DATE: 9-11-2018
2018.0021.01
SHEET
C-8

ISSUE FOR BIDS: 9-11-2018

Thursday, September 13, 2018 8:58:40 AM

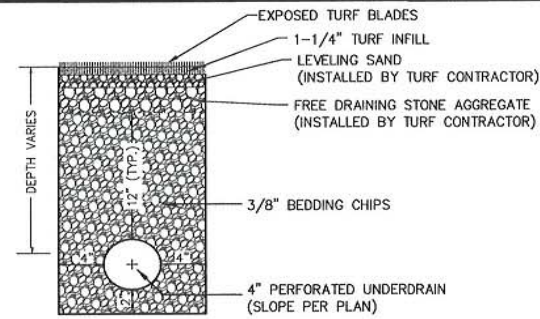

1 4" PIPE UNDERDRAIN DETAIL
(SYNTHETIC TURF BULLPENS/
BATting CAGES)
NOT TO SCALE

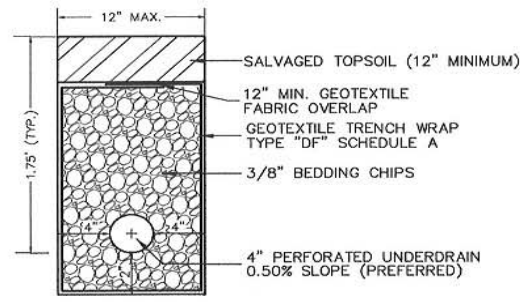

2 4" PIPE UNDERDRAIN DETAIL
(DRAINAGE SWALE)
NOT TO SCALE

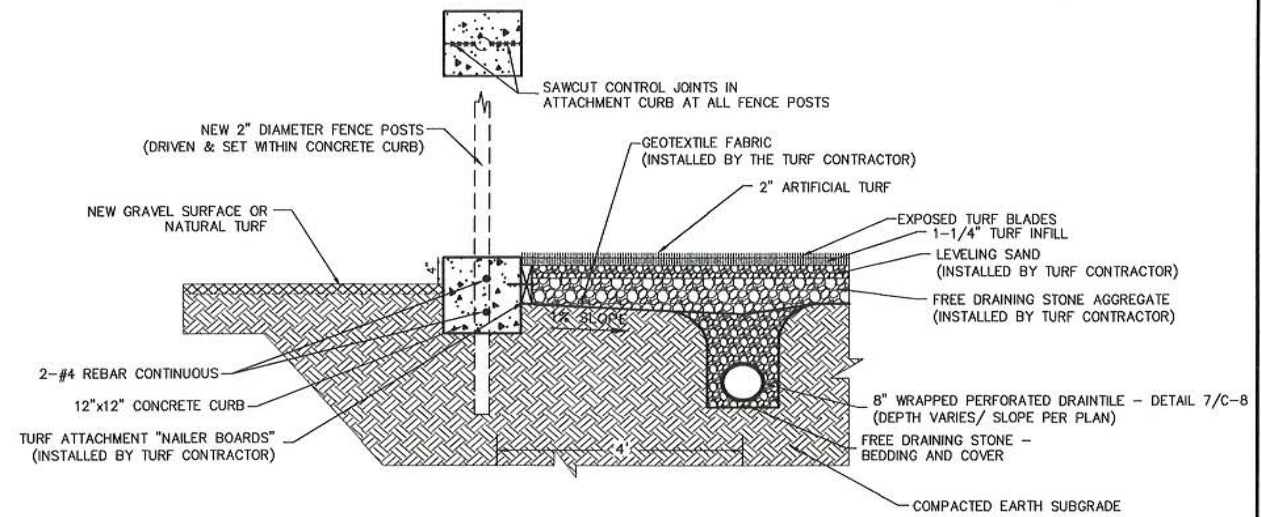

5 ATTACHMENT CURB C DETAIL
(SYNTHETIC TURF/NATURAL TURF OR GRAVEL TRANSITION)
NOT TO SCALE

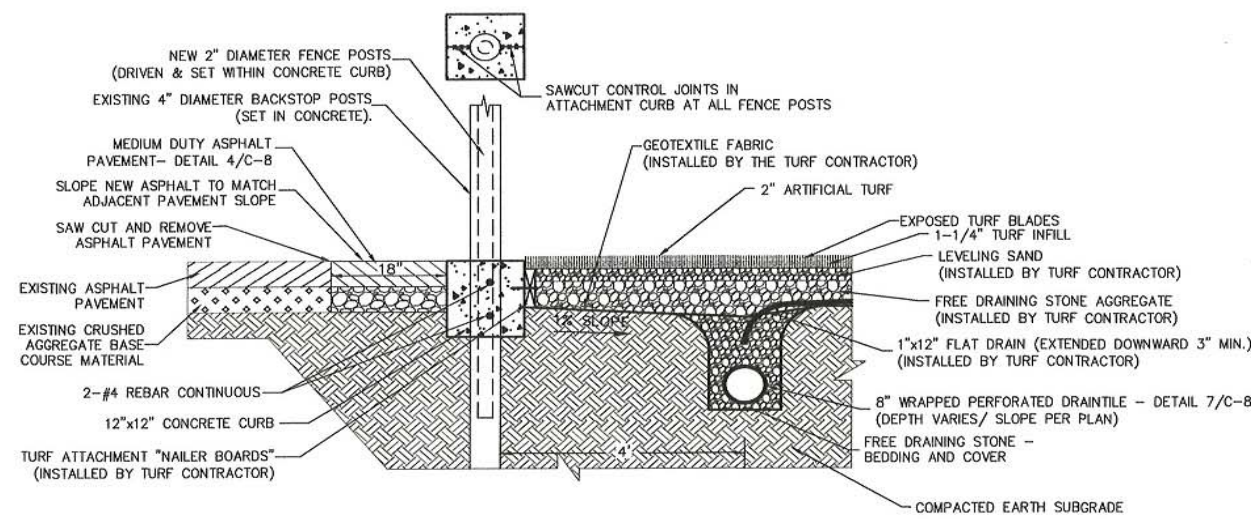

3 ATTACHMENT CURB A DETAIL
(SYNTHETIC TURF/ASPHALT PAVEMENT TRANSITION)
NOT TO SCALE

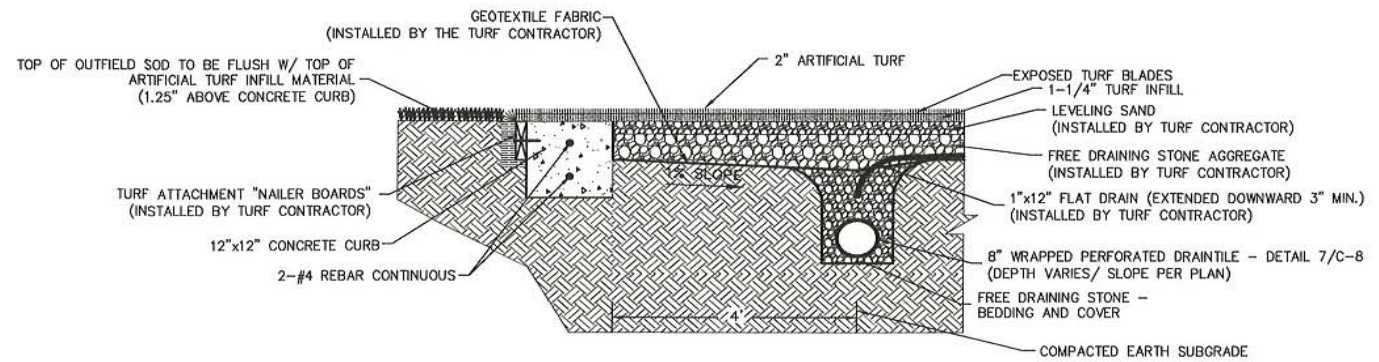

6 ATTACHMENT CURB D DETAIL
(SYNTHETIC TURF INFIELD/NATURAL
TURF OUTFIELD TRANSITION)
NOT TO SCALE

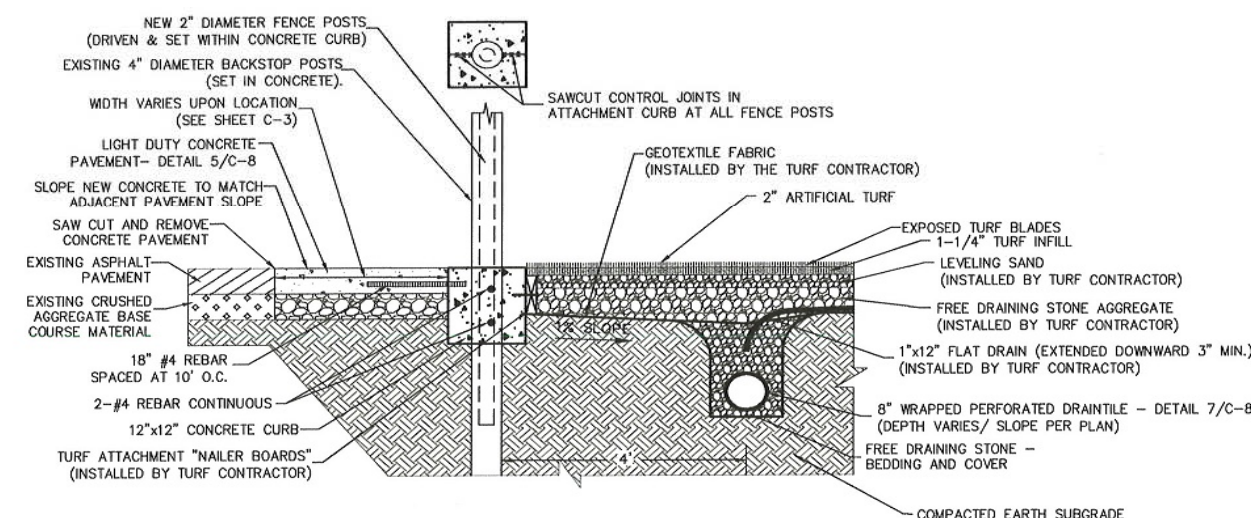

4 ATTACHMENT CURB B DETAIL
(SYNTHETIC TURF/CONCRETE PAVEMENT TRANSITION)
NOT TO SCALE

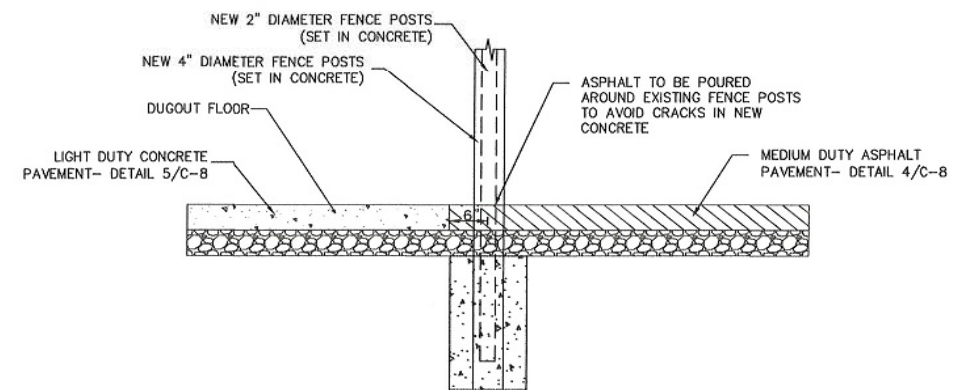

7 DUGOUT PAVEMENT DETAIL
(CONCRETE / ASPHALT / FENCE POST TRANSITION)
NOT TO SCALE



Nielsen Madsen + Barber
CIVIL ENGINEERS AND LAND SURVEYORS
1458 Horizon Blvd. Suite 200, Racine, WI. 53406
Tel: (262)634-5588 Website: www.nmbssc.net

HORLICK ATHLETIC FIELD
FOR
RACINE PARKS DEPARTMENT
CITY OF RACINE, RACINE COUNTY, WISCONSIN
TYPICAL SECTIONS & CONSTRUCTION DETAILS

NO.	REVISION	BY	DATE

PROJ. MGR: MDE
DRAFTED: JEG
DATE: 9-11-2018
CHECKED: ALJ
DATE: 9-11-2018

2018.0021.01

SHEET
C-9

INSTRUCTION TO BIDDERS

The specifications shall be held to include the Advertisement, Instructions to Bidders, Manufacturer's Qualifications, General Conditions, Proposal, Contract and Specifications.

All bids shall be made out as directed in the specifications and shall be on the Standard Proposal form furnished by the City of Racine. Any bid not on this form will not be accepted. Failure to comply with these requirements may result in rejection of bidder's proposal. **Bids will be placed in a sealed envelope and marked with the words "OFFICIAL NOTICE #11-2019" Please return this entire bid package with your bid.**

Bids are to be State and Federal Tax Exempt. A tax exemption certificate will be furnished to the successful bidder. No bid may be withdrawn after the time for opening bids.

Payment for the work will be in cash upon completion and acceptance of the work unless otherwise specified. If monthly payments are made, they will be made as set forth in the contract.

The City of Racine reserves the right to reject any or all bids or to accept any bid considered most advantageous to the City. It also reserves the right to waive any informality in bids received whenever such waiver is in the best interest of the City of Racine.

The accompanying bid includes the furnishing of all materials, labor and equipment required by the attached specifications, which I have carefully examined, and I hereby certify that the statements made herein are true and correct.

The undersigned represents that the prices in the accompanying bid are neither directly or indirectly the result of an agreement with any other bidder.

COMPANY: _____

ADDRESS: _____

CITY, STATE: _____

SIGNATURE: _____

PRINTED NAME: _____

BIDDER'S CERTIFICATION

I hereby certify that all statements herein are made in behalf of:

Name of Corporation, Partnership or Person submitting bid

a corporation organized and existing under the laws of the State of:

a partnership consisting of:_____

an individual trading as:_____

of the City of _____ State of _____

that I have examined and carefully prepared this proposal from the plans and specifications and have checked the same in detail before submitting this proposal; that I have full authority to make such statements and submit this proposal in its (their) behalf, and that said statements are true and correct

SIGNATURE:_____

TITLE:_____

Sworn and subscribed to before me

this _____ day of _____ 20_____.

(Notary or other officer authorized to administer oaths)

SEAL:

My commission expires_____